

BUSHTON MANUFACTURING

Makers of



Warranty page 2 History of Bushton Manufacturing and Hawk Tools, Contact and Ordering information on page 3 *Since 1929*



Scroll saws page 4-5
Accessories page 6
Parts pages 7-9
Supplies page 10



RouterSHOP

pages 11-13



JointABILITY pages 14-15

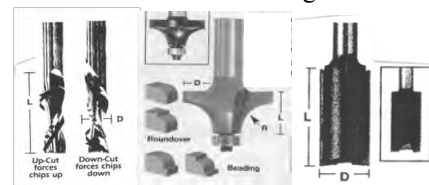

Router Bits Pages 16-17

Clamping pages 20-23
Bishop CLAMP pages 20-21
BushtonCLAMP page 23
VerticalCLAMP page 22
OrthoCLAMP page 23



PanelMASTER pages 24-26

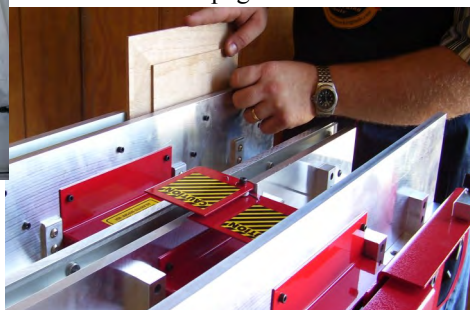

MultiFUNCTION
Planer/Molder/Gang Saw/ Sander
Planer pages 31-35



Rosette Cutters and Knives

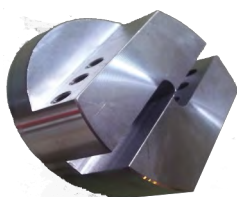

Freeborn Cutters



pages 27-30

Atompop
Popcorn Popper
page 36



To Order
call 620-562-3557

e-mail at customerservice@hawkwoodworkingtools.com
or online at www.hawkwoodworkingtools.com

Catalog #7, February 2014

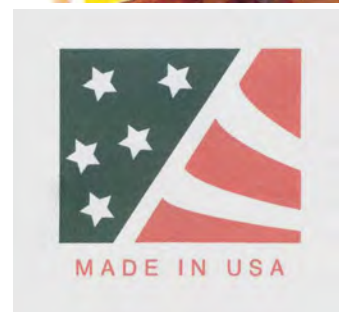



Whether your project is
Large or Small
Complex or Simple
Wood, Plastic, Glass, Soft Metals, Stone, Tile, etc.
If you're a beginner or expert
The

HAWK
Precision Scroll Saw™

is the saw you need because the

HAWK
DOES IT ALL

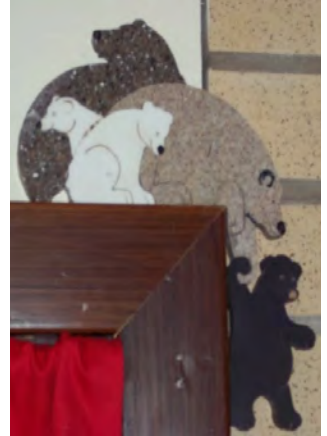

LIMITED WARRANTY

PRICES SUBJECT TO CHANGE WITHOUT NOTIFICATION

We guarantee that all Hawk Products are free from defects in materials and workmanship for one full year from the date of purchase. This warranty is automatically started when we ship your new Hawk Product. The warranty is tied to the original owner and is non-transferable. If given as a gift, tell us who it is to and what day the gift will be given so that the warranty can be properly registered. The warranty covers parts only; labor and shipping charges still apply.

This warranty does not obligate us to bear the cost of shipping charges in connection with the repair or replacement of the defective parts, nor shall it apply to any machine upon which repairs or alterations have been made unless authorized by us. This warranty is void if damage is the result of misuse or abuse of the machine. This warranty is non-transferable. Tampering with any electrical control components voids this warranty.

When receiving a freight item from a common carrier, the customer must note on the receipt any damage to the carton. This is required for all insurance claims. If you do not note any damage to the shipping carton, you assume the cost of any damages caused by shipping that are not covered by insurance.

We shall in no event be liable for consequential damages or contingent liabilities arising out of the use of any machine, or out of the failure of any machine to operate properly. No express, implied or statutory warranty other than herein set forth is made or authorized to be made by us.

Warranty information will be based on information given at the time of purchase. This warranty is not transferable from one owner to another. Any repairs and or replacement parts must be done by Bushton Manufacturing, LLC. In order for parts to be honored by this warranty, the part must be official Hawk Woodworking Tools parts supplied by Bushton Manufacturing, LLC.

BUSHTON MANUFACTURING, LLC

HISTORY BUSHTON MANUFACTURING

While Nilus Orth was in graduate school for mechanical engineering at the University of Kansas in the late 1980's, Loren Orth asked Nilus to start conducting research for him on using agricultural waste to make products. He continued this into the '90s while working as an assistant professor at Lamar University. In '95 Nilus left Lamar and the brothers formed Wheat Straw Products as a research company. A few years later they started Bushton Manufacturing as a manufacturing company for the products they had developed and purchased.

In 2005, the Orth brothers purchased the products for J & D. In 2006, a third brother, Linus, joined Loren and Nilus to purchase Quincraft Products. They retained the name and product as a separate company.

By 2009, Loren and Nilus knew that the beach maintenance equipment that they had been making since acquiring J & D would not sell until the US economy improved. They were always looking for more opportunities and knew they would need additional products.



HOW WE AQUIRED RBI

In early April 2009, Nilus was in Kansas City picking up equipment that Quincraft Products had purchased. While there, he read the Kansas City Star and saw the sale bill for a manufacturer closure and liquidation auction. Even though it did not say who it was, the bill stated 'the inventory for the products made' was for sale. Assuming there was a product-line involved, Nilus and Loren contacted the auctioneer and found out it was Hawk Wood Working Industries (formerly RB Industries). Deciding that they were interested, the brothers set off for Garden City, Missouri immediately. After looking at the equipment, parts, etc., they contacted the owners and expressed their interest.

After 10 days of receiving information on the company, studying the product and looking over the equipment, Bushton Manufacturing made an offer. On April 14, 2009 a verbal agreement was reached and a tentative agreement was signed on April 15, 2009.

Bushton Manufacturing started taking calls and shipping parts after moving Hawk from Garden City, Missouri to Bushton, Kansas on May 13, 2009; just 29 day later.

HISTORY PREWITT/RBI

J. R. Prewitt in Pleasant Hill, Missouri founded J. R. Prewitt and Son Machine shop in the mid 1920s. They went on to develop the Belsaw planer in 1929, the first of a product line that they would expand and continue to this day as the Hawk Wood Working Tool line.

J. R. Prewitt and his wife had 14 children, 7 boys and 7 girls, all of whom were active in the company. After J. R. Prewitt's death in 1951, the control of the company passed to his youngest son, Ralph, who managed the company for the next 20 years until its sale to Verle L. Rice in 1972.

By 1976 Rice had reincorporated it as R. B. Industries. Two years later, R. B. Industries had developed their own thickness planer to be marketed under the name RBI. In the early '80s RBI released a series of scroll saws including the Falcon, Eagle, Condor, and Hawk. The Hawk proved to be the biggest seller, prompting RBI to rename their saws as the Hawk product line, and in time, the rest of their products were renamed as HAWK products. In 1984 the growing company was moved from Pleasant Hill to Harrisonville, Missouri.

Verle L. Rice passed away in 2006 and in 2007 the family sold R. B. Industries to an investment company which renamed it Hawk Wood Working Industries. The company began a move to Garden City, Missouri, but the company never completed the move. The decision was made to close the doors on March 2, 2009, and an auction was scheduled for April 16, 2009.

CONTACT INFORMATION

You can reach our customer service department Monday thru Friday from 8:30 am to 5:30 pm Central Time.

Bushton Manufacturing, LLC
P.O. Box 127
319 South Main Street
Bushton, KS 67427

Phone: 620-562-3557
e-mail: customerservice@hawkwoodworkingtools.com
Web: www.hawkwoodworkingtools.com

ORDERING INFORMATION

To order you can contact customer service by mail, phone or e-mail as listed on top of this page.

You will need to provide the item number, description and quantity you want.

You can pay by check, money order, MasterCard, VISA, Discover, or American Express Card.



MAKE CHECKS PAYABLE TO:

BUSHTON MANUFACTURING, LLC

We do not have a set shipping and handling charges table at this time. Please contact customer service for the amount of these charges for your order if needed.

We now have a direct order shopping cart on our web page.

The web page is www.hawkwoodworkingtools.com



HAWK

Precision Scroll Saw™

We can cut whatever you want.
If it is intarsia, fret work, puzzles, toys etc.
In the material you wish use.
If you need to cut wet or dry we can handle your needs.



BM-26
\$1400 WITH STANDARD LEGS
\$1500 WITH CHAIR LEGS
\$1350 WITH BENCH LEGS

Our saws will cut almost anything from soft to hard woods; manufactured type woods such as plywood, veneer, mdf, particle board, melamine; other organic fiber materials such as paper; plastics of all kinds; organic material such as horns, antlers and bones; glass and ceramic tile; soft to hard stone; soft metals precious or non-precious such as aluminum, copper brass, silver, and gold.

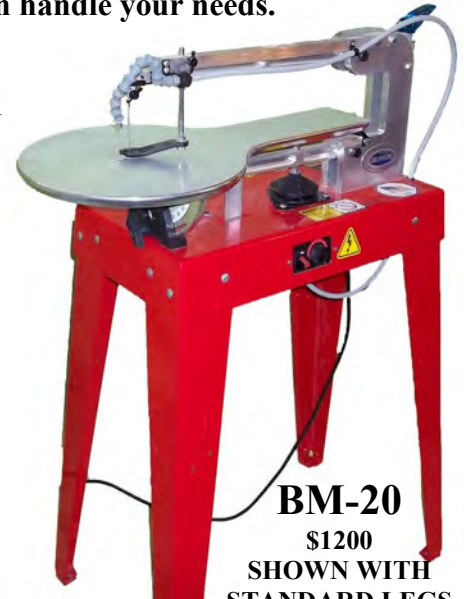

BM-20
\$1200
SHOWN WITH STANDARD LEGS



BM-20
\$1300
SHOWN WITH CHAIR LEGS



BM-20
\$1150
SHOWN WITH BENCH LEGS

SPECIFICATIONS

	BM-20	BM-26
Throat Capacity	20"	26"
Maximum Cutting Thickness	2 1/2"	2 1/2"
Cutting Strokes per Minute	100-1750	100-1750
Work Table	13 1/2"	13 1/2"
Cutting Table Height		
Standard Legs	39"	39"
Standard legs w/exten	43 1/2"	43 1/2"
Chair legs	31 to 38"	31 to 38"
Bench Legs	13"	13"
Distance between chair legs	27 1/4" minimum	27 1/4" minimum
Maximum forward tilt (extension on back legs only)	15 Degrees	12 Degrees
Table Over Hange	7"	7"
Motor	DC TENV	DC TENV
Mounting	10 Gauge Steel Legs	10 Gauge Steel Legs
Weight	93 Pounds	97 Pounds
Floor Space Requirements	19 1/2" x 33"	19 1/2" x 39"
Manufacturer's Warranty	1 Year all parts and labor	1 Year all parts and labor
Shipping Dimensions		
Box # 1	39" x 21" x 20" 96#	39" x 21" x 20" 103#
Box # 2 Standard Legs	7" x 7" x 37" 30#	7" x 7" x 37" 30#
Box # 2 Chair Legs	7" x 7" x 37"	
Box # 2 Bench Legs		

FEATURES

Long 7/8" Blade Stroke for faster, cleaner cuts that need little sanding, if any at all.



Large Cast Aluminum Table (13 1/2" diameter) provides a large work area in front of the centrally located blade for better control and more support of your work.

Work Table Tilts a full 45° both left and right.

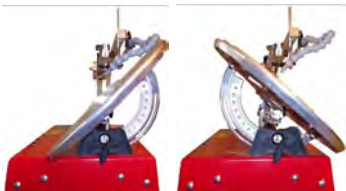

Pressure Foot gives maximum control, even when making those intricate cuts that are so popular with scroll saw users.

Precision Crafted Steel Base and Heavy Duty Legs made from 10 gauge steel for greater stability and long-lasting durability.

Use Any 5" Pinless Blade to make clean, polished cuts that need little to no sanding. We stock many types of blades from multiple manufacturers to ensure we have a blade that fit your needs. You can cut hard or soft wood, plywood, MDF, particle board, OSB, plastic, Corian, glass, ceramic tile, soft stone (sand stone, lime stone, etc.), hard stone (marble, granite, etc.), non-ferrous metals, horn, antler, and much more.



Front Cam Over tension release of the upper blade holder allows you to change blades in seconds. This allows you to make inside cuts quicker and easier.

Quick Change Blade Holders. Both the bottom and top blade holders clip into place. This allows you to have either blade holder preloaded for quick blade type change out.

Machined and Casted Parts for quality to last a lifetime.

BM-Series improvements over the ULTRA series

Upper Arm is 38% lighter but still stronger in the direction needed.

Lower Arm is 34% lighter but still stronger in the direction

THESE IMPROVEMENTS ALLOW US TO INCREASE THE MAXIMUM STROKES PER MINUTE BY 100 TO 1750

Motor Bearing Block is integrated into a custom motor.

Counter Weight is used, not just a flywheel.



Top or Bottom Feed. Which lets you choose the way you prefer to insert the blade for your fret work.

Rear Cam Over for quick release and precise setting of blade tension. More accurate than plucking the blade and turning a knob.

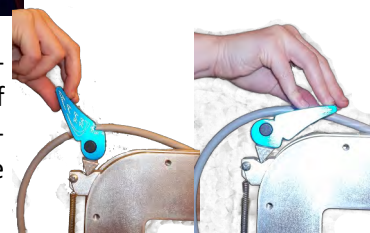

Table-Forward Design is comfortable to sit at with a shop stool.

Adjustable Nose allows you to tilt the blade slightly for more aggressive cutting.



Safety Spring and Stop for safer operation even if the blade breaks.



Flex Bellows and Loc-line keeps the cutting area clear for greater visibility and safety.

Totally Enclosed DC motor gives you complete control of the speed throughout the entire speed range. The motor is TENV to keep out harmful dust. The controller is designed to yield full torque over the entire speed range without over heating or stalling.

Engineered to run quiet and limit vibration.

Made in the United States of America.



Adjustable Nose on lower arm. Like the G4 and the JuniorHAWK the tilt of the blade is infinitely adjustable rather than two position slots for the lower blade holder like on the ULTRAS.

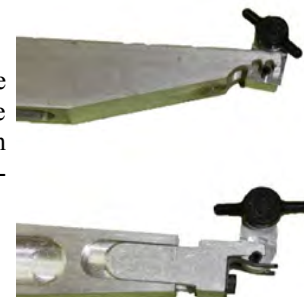

ACCESSORIES



965-0950 Chair Leg Kit
\$230.00

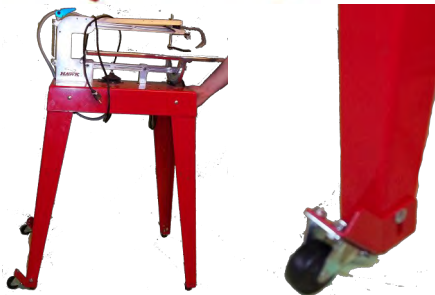

965-1910 Saw Caster Kit \$44.95
When you lift on the opposite end the saw lifts on to the casters for easy movement



965-1151 Leg Extension Kit, 2 extensions per kit \$39.96
To tilt the saw forward use only one pair on back legs of the saw.



865-0803 6 pack blade tubes \$7.75

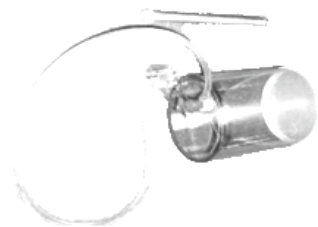

865-0300 Drip Tank for use with Diamond Blades \$64.95



865-0100 Foot Switch \$24.95



965-0245 Accessory Table \$29.95

865-0804 Blade Tubes for Acc. Tray \$1.49

- 865-2210 45" Articulated Mag Light \$75.00
- 865-2211 Bulb for Mag Light \$7.50
- 865-2212 3-Diop Lens for Mag Light \$19.95
- 865-2213 5-Diop Lens for Mag Light \$19.95
- 965-0200 Blade Holder Rack \$12.95



MINI DRILL DRILL BITS



866-0000 \$7.50

JOBBER LENGTH			
ITEM #	SIZE	DIA	PRICE per 5
866-0055	#55	.0520"	\$ 3.68
866-0056	#56	.0465"	\$ 3.68
866-0057	#57	.0430"	\$ 4.55
866-0059	#59	.0410"	\$ 4.55
866-0063	#63	.0370"	\$ 4.55
866-0065	#65	.0350"	\$ 4.99
866-0068	#68	.0310"	\$ 4.99
866-0070	#70	.0280"	\$ 6.56
866-0071	#71	.0260"	\$ 6.56
866-0076	#76	.0200"	\$ 11.50
866-0077	#77	.0180"	\$ 11.50
866-0102	1/32	.0313"	\$ 3.90
866-0103	3/64	.0469"	\$ 3.90
866-0104	1/16	.0625"	\$ 3.90
866-0105	5/64	.0781"	\$ 4.10
866-0106	3/32	.0938"	\$ 4.10
866-0107	7/64	0.1094	\$ 4.10
866-0108	1/8	.1250"	\$ 4.10
DIAMOND			
866-0203		.75 mm	\$ 8.00
866-0204		1 mm	\$ 8.00
866-0205		1.25 mm	\$ 8.00
866-0206		1.5 mm	\$ 8.00



PARTS SCROLL SAWS

BLADE HOLDERS

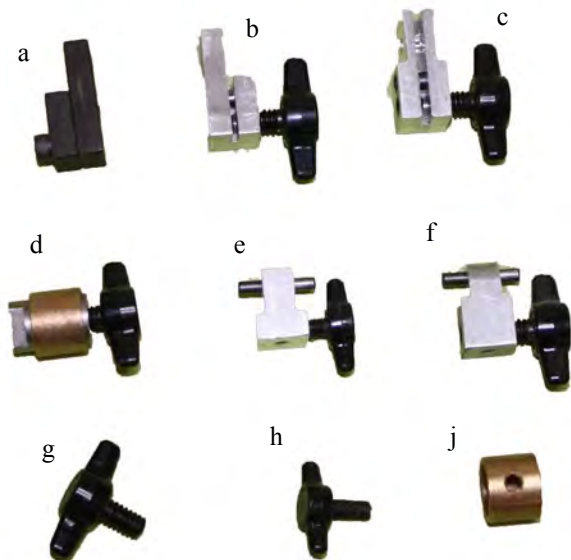

a	615-0045	Upper old style 2 piece	\$19.95
b	615-0182	Upper old style 1 piece thumb screw	\$19.95
c	615-1182	Upper ULTRA	\$19.95
	615-1182A	Upper ULTRA Style blade holder for use with 705-0153 blade holder bracket	\$19.95
d	615-0187	Lower Barrel type with bushing	\$19.95
e	615-1231	Lower ULTRA	\$19.95
	955-0003	Replaced by 955-1010	
f	955-1010	G4 upper & lower	\$19.95
g	715-0221	1/4-20 T-Knob	\$1.95
h	715-0257A	#10-32 T-Knob	\$1.95
j	715-0112	Bronze Bushing for Barrel Type	\$2.95
k	705-0086	9/64 T-Handle Allen Wrench	\$4.00
m	715-0137	F Wrench for barrel type blade holders	\$4.95
	715-0256	10-32 x 3/16 Flat Point Socket Head Set Screw	\$0.60
	791-0053	1/4-20 x 1/4 Flat Point Socket Head Set Screw	\$0.50

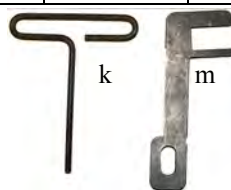

UPPER BLADE HOLDER BRACKET

All saws with front cam tension release will now use upper blade holder bracket 715-0153. To use this bracket all cams must be replaced with 715-2154. Upper blade holder 615-1182A is for use with this new bracket except on the G4 and JuniorHAWK saws which use upper blade holder 955-1010.

All the parts required for this conversion for any VS series saw are in item #960-1232 for \$48.90

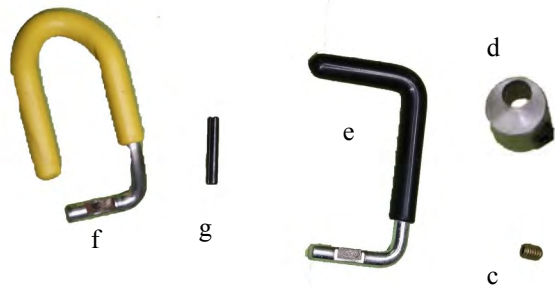

a	705-0153	Upper Blade Holder Bracket Assembly	\$11.50
b	711-0013	Steel Blade Holder Retainer	\$1.95
c	715-0287	#10-32 x 1/4 Lg Nylon Insert Brass Set Screw	\$1.50
d	715-2154	Cam	\$12.50
e	715-2168	Cam Handle	\$4.95
f	715-3169	Cam Handle G4	\$4.95
g	710-0042	1/8 x 3/4 Lg Roll Pin	\$0.50

LOWER BLADE HOLDER BRACKET

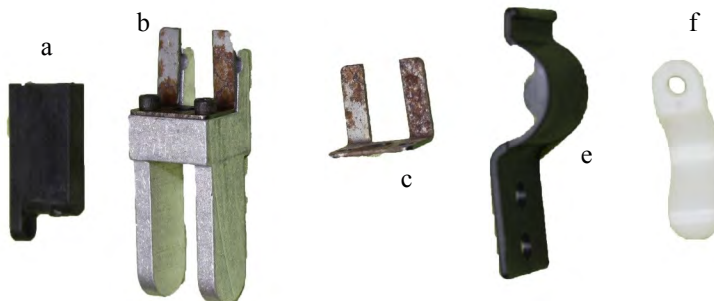

item	part #	description	use with	price
a	715-0001	Adj Stroke Block	for G4 saws	\$4.95
b	711-0014	Nose Adj Stroke	use on G4, JuniorHAWK and BM series	\$12.95
c	711-0012	Retainer Clip for Nose Adj Stroke	use with 711-0014	\$1.95
d	711-0100	Nose Adj Stroke Assembly	use to replace 705-0005 and 705-0015 on G4 saws	\$15.95
e	715-2139	Blade Holder Clip Barrel Type	for use with 615-0187 barrel style lower blade hold-	\$1.95
f	715-0099	Blade Holder Clip ULTRA	for use with 615-1187 style lower blade holders	\$1.35

TENSION ROD PARTS

ULTRA SERIES

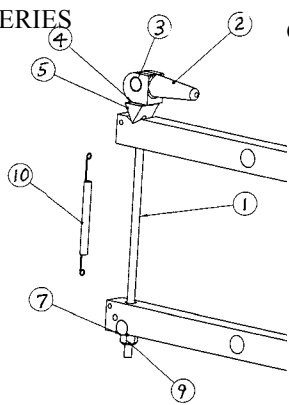

G4 SERIES

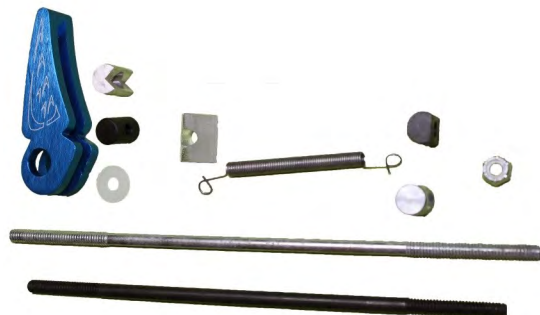
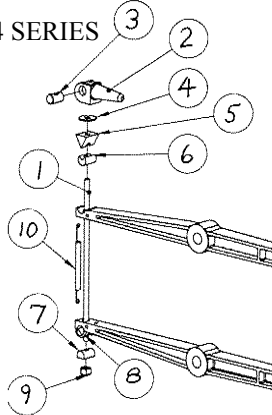

1	715-1272	Tension Rod 9-5/8"	\$3.50
	715-0240	Tension Rod 8-1/2"	\$3.50
	715-0272	Replace with 715-1272	
2	615-1074	Replace with 705-0024	
	705-0024	Cam Rear Tension	\$11.00
3	715-0077	Round Pivot for Rear Cam Handle	\$6.42
4	715-0103	Nylon Washer	\$1.00
5	715-0075	Wedge Pivot	\$7.75
6	605-0039	Wedge Pivot Adapter	\$4.95
	715-0216	Round Pivot Bottom	\$4.95
7	715-0216	Round Pivot Bottom	\$4.95
	705-0038	Round Pivot Bottom	\$4.95
8	715-0017	Retainer Round Pivot Bottom (G4)	\$5.95
9	715-0079	5/16-18 Nylock Nut	\$1.00
10	710-2036	Saw Arm Safety Spring	\$3.95
	960-1231	Ultra tension rod kit	\$33.12

ACCESSORY ARM



ULTRA SERIES

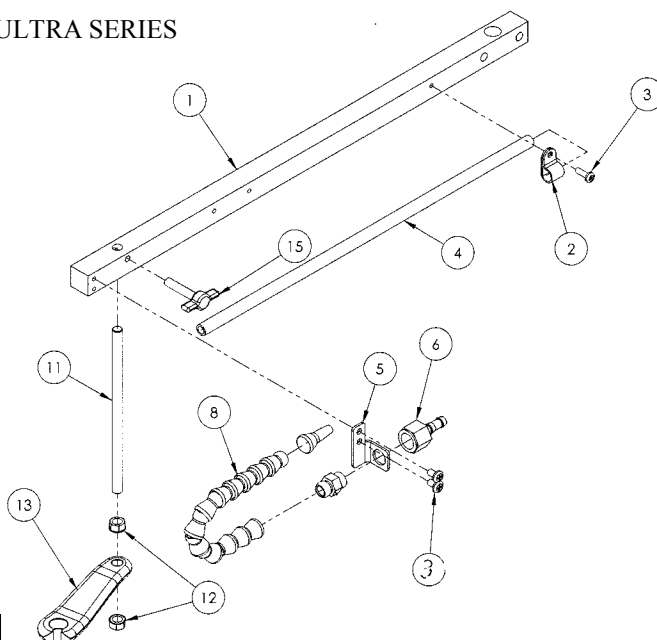

G4 SERIES

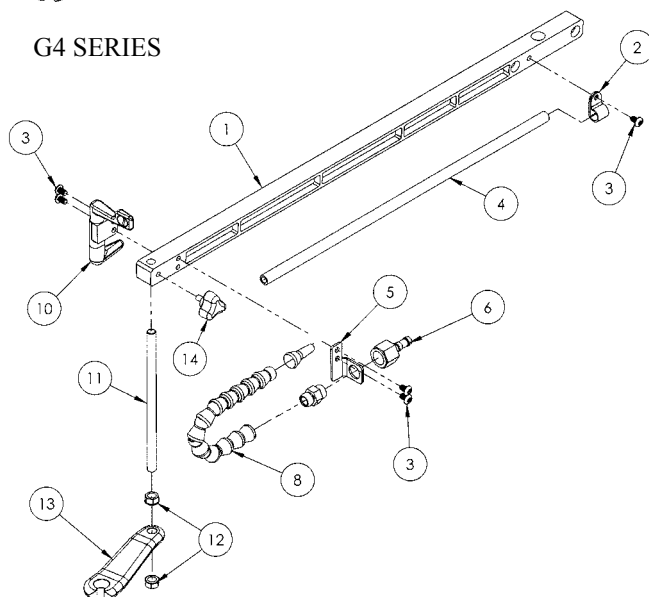

1		Accessory Arm	
2	715-0275	Tubing Clamp	\$0.50
3	705-0110	10-32 x .3125 Lg Button Head Screw	\$0.50
4	715-0274A	3/8 Ploy Tubing 55"	\$6.25
5	505-0004	Bracket for Blower Nozzle	\$3.00
6	715-0308	NPT to Hose Barb	\$2.49
8	715-0321	Loc-line, w/Nozzle and 1/4 NPT	\$9.50
10	605-0030	Upper Arm Retainer (G4)	\$12.95
11	785-2012	Hold Down Rod	\$3.50
12	770-0080	5/16-18 Flange Nut	\$0.50
13	715-0104	Hold Down Foot	\$3.95
14	705-0027	10-32 x .500 Lg Knob	\$3.95
15	715-0222	1/4-20 x 1-1/4" Lg T-Knob	\$1.95
	715-0024	Bellows	\$9.95
	715-0273	Grommet	\$0.50
	715-0330	Loc-line Upgrade Kit	\$19.95

MOTORS

SINGLE SPEED AND BELT DRIVE SAWS

ES-44-Z FASCO Motor for many of the single speed saws. \$119.00



VARIABLE SPEED AC MOTOR REPLACEMENT

We can no longer obtain new motors or controllers for the ac variable speed motors. To solve this problem we have developed this replacement kit.

711-1000 DC replacement motor, controller, bracket, counter weight \$350.00



DC MOTORS ULTRA AND G4 SERIES SAWS

We have found 8 different motors, 4 different controllers and 3 different connection methods that were used on these saws. In order for your motor to run properly, we ask that you send in both the motor and controller to us. Then we can set the controller to the motor that is shipped to you. That is if you need a new controller we set it to your motor or if you need a new motor, your controller is set to the new motor. This will result in better performance of your saw.

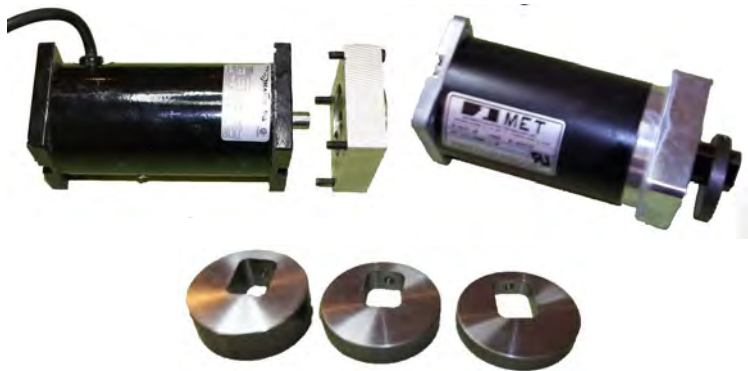

- 704-4013 The BM series custom MET motor has an integrated bearing block, which allows for the use of a counter weight not just a flywheel. This motor is designed to be a replacement for the ULTRA and G4 series saws. For use with the counter weights listed below. \$190.00
- 715-2259 Controller for the dc motors \$159.00
- 615-1263A Counterweight for 16" saws and upgrade kit. \$22.50
- 615-1263B Counterweight for 20" saw \$25.00
- 615-1263C Counterweight for 26" saws \$27.50

BEARINGS



735-0007	Bearing 1/2 Pitman & some pre 1990 Saw Arms	\$15.00
735-0008	Bearing 3/8 Pitman	\$4.95
715-0208	Bearing 1/2 Thrust Washer Type	\$6.95
715-1208	Bearing 1/2 Thrust	\$4.95
715-0264	Bushing 1/2 ID 5/8 OD x .730 LG	\$2.95
740-0369	Bushing 1/2 Flanged	\$2.50
705-0029	Bearing Polymer 1/2 ID x 1	\$2.95
715-0262	Bearing Carrier Ultra/G4 Models	\$10.50
735-0009	Bearing 1/2 for many Motors	\$17.50

OTHER PARTS



Our parts list is far too large to cover in this catalog.

Let us know what parts you need and we will do our best to get the right part to the right place as quickly as possible.

BELTS

- 705-0073 Belt for -3 models and high speed belt for 2-speed models \$18.32
- 705-0072 Belt for lower speed on 2-speed models \$18.32
- 745-0059 Belt for 226M \$6.50



REBUILD SERVICE

We can rebuild your saw or other machine for \$50 per hour plus parts. You can send in the entire machine or just the parts you need rebuilt; like an upper arm. A complete rebuild of a scroll saw usually require 3 hours. If we have to re-machine parts, it can require a little more time. An upper arm rebuild takes about 30 minutes. After we examine your tool we will call and tell you what it will cost before we start on the rebuild.

PATTERNS AND BOOKS



870-0000	Scroll Saw Work Book	\$14.95
870-0001	Big Book of Scroll Saw Woodworking	\$24.95
870-0002	Scroll Saw Pattern Book	\$14.95
870-0003	Scroll Saw Relief	\$14.95
870-0100	Wooden Puzzles	\$17.95
870-0200	Classic Fretwork Scroll Saw Patterns	\$14.95
870-0300	Scroll Saw Portraits 2nd Edition	\$14.95
870-0301	Wild West Scroll Saw Portraits	\$12.95
870-0302	Scroll Saw Civil War Portraits	\$12.95
870-0400	Artistic Wildlife Projects for the Scroll Saw	\$19.95
870-0401	Make your Own Model Dinosaurs	\$14.95
870-0501	Words of Faith in Wood	\$14.95
870-0600	Big Book of Christmas Scroll Saw Projects	\$17.95
870-0700	Great Book of Wooden Toys	\$19.95
870-0701	Zany Wooden Toys that Whiz, Spin, Pop and Fly	\$19.95
870-0800	Wooden Bowls	\$19.95
870-0900	Scroll Saw Castles	\$12.95
870-1000	Intarsia for Beginners	\$19.95
870-1100	HAWK Scroll Saw Patterns	\$10.95
870-1101	HAWK 26 Artisan Quality Projects CD	\$29.95
870-1102	HAWK Mini-cutouts CD	\$15.95

CHEMICALS



865-0056	Rust Free 10.5 oz.	\$10.99
865-0070	Bit and Blade 10.5 oz.	\$10.99
865-0069	T-9 Table & Blade Lube	\$15.99
865-0072	Top-Saver	\$19.95
865-0071	Dry tool Spray Lube	\$19.95
865-0073	Clearco 600 Adhesive	\$10.95
865-0074	Blade Lube Stick	\$ 5.90
865-0065	Loctite tube	\$.44

BALTIC BIRCH PLYWOOD



Item #	Thickness	Size	Price
865-4000	1/8"	12x12	\$1.75
865-4001	1/4"	12x12	\$2.20
865-4002	3/8"	12x12	\$2.70
865-4003	1/2"	12x12	\$2.90
865-4010	1/8"	12x30	\$4.10
865-4011	1/4"	12x30	\$5.25
865-4012	3/8"	12x30	\$6.50
865-4013	1/2"	12x30	\$7.00

MANUALS



We have the manuals you need. Call in or e-mail your model and serial number and we will e-mail you a PDF for free or mail you a hard copy for \$5.00 plus \$2.50 for shipping and handling charges. PDF file can be as large as 20 meg and some e-mails accounts cannot accept that large of an e-mail. Manuals are also available online at hawkwoodworkingtools.com.

ENGINEERS SQUARE

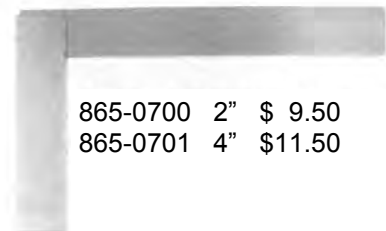

865-0700	2"	\$ 9.50
865-0701	4"	\$11.50

SCROLL SAW BLADES FOR EVERY NEED

Not all scroll saw blades are the same. The differences include the hardness of the metal it is cut from, the method of cutting the tooth, the geometry of the tooth and others. Each of these affects how the blade cuts in different material.

The speed at which the blade moves and the rate you feed the material you are cutting also makes a difference. That is why all of our scroll saws are variable speed.

To ensure that you can cut any material you choose, we stock a large selection of scroll saw blades from four different sources.

The blades are listed in the chart in the centerfold of this catalog

Which blade and what cutting speeds work for you on a given material will be up to you to decide. But here is our list and some starting-point recommendation on blade uses.

866-4000 **Variety Pack** which includes one dozen each of 866-7002, 866-7005, 866-7012, 866-7107, 866-7209, 866-6025, 866-6143 and 866-5407 each in our rectangular blade tubes. For: \$27.00

ABRASIVE CORD AND TAPE



Item #	Description	Price
866-7950	Abrasive Cord .070 x 12' Fine Grit	\$ 5.95
866-7951	Abrasive Cord .070 x 50' Fine Grit	\$ 24.95
866-7952	Abrasive Cord .055 x 12' Med Grit	\$ 5.95
866-7953	Abrasive Cord .055 x 50' Med Grit	\$ 14.95
866-7954	Abrasive Tape 3/32 x 12' Med Grit	\$ 5.95
866-7955	Abrasive Tape 3/32 x 50' Med Grit	\$ 15.95
866-7956	Abrasive Tape 3/16 x 12' Med Grit	\$ 6.45
866-7957	Abrasive Tape 3/16 x 50' Med Grit	\$ 17.95



940-0050

DUST COLLECTOR, FENCE,
SLIDING MITER GAUGE, STOPS,
FEATHER BOARDS, PUSH STICKS,
DEPTH GAUGE, FREE HAND PINS
ALL INCLUDED FOR ONE PRICE OF
\$800

THE AFFORDABLE SOLUTION TO VERSATILE WOODWORKING

THERE IS NO OTHER MACHINE THAT COMPARES.

There is no other tool that gives you the versatility of the **HAWK RouterSHOP**. The good news is it does not take thousands of dollars worth of equipment or decades of experience to create top notch woodworking projects. The **RouterSHOP** is the tool woodworkers use to build their projects.

As soon as you start to use the **RouterSHOP**, you will see just how different this tool really is. It will increase the accuracy in your project building and give you the confidence to take on the type of projects you would have only dreamed of in the past. The **RouterSHOP** has stops and guides to keep track of measurements and adjustments to save you time and improve accuracy. **The RouterSHOP comes complete with the sliding miter gauge, zero clearance inserts, feather boards, free hand guide pins, stop blocks, and step by step instructions**, which all but eliminates the need to build jigs so that you can get on with your project.



FEATURES

- **CROSS FEED ADJUSTMENT SCREW AND SCALE** makes set up of repeated cuts simple and accurate.
- **MAGNETIC STAINLESS STEEL WORK TABLE** is 20-1/4" by 30-1/2" to give you the work area you need.
- **SPLIT TABLE DESIGN** allows you to tilt the router with respect to the work piece allows for cutting bevels with a straight cut bit. You can cut elaborate edges with just one bit by using multiple pass resetting the table between passes.
- **ZERO CLEARANCE INSERTS** give your work piece support where it needs it.
- **PRECISION SLIDING MITER GAUGE** with stops has HDPE faces that can be removed or replaced to allow for material support when needed to prevent blowouts. The dovetail track gives accurate repeatable travel to the miter gauge and the stop ensure that you only cut what you want.
- **PRECISION ALUMINUM FENCES** with stops help ensure accurate cuts that stop where you want them to.
- **UNIVERSAL MOUNTING PLATE** allows for attachment of any router you wish to use. **TABLE MITER GAUGE** is large and easy to read for setting the tilt of the table.
- **DUST COLLECTOR ATTACHMENT** connects to a standard shop vacuum.
- **SHELF BRACKETS** the RouterSHOP has brackets for two shelves under it (you supply the shelf boards).
- **NOW USING PRECISION HINGES**
- **MADE IN THE USA**

THE FIVE ADVANTAGES OF THE RouterSHOP

USING THE RouterSHOP IS FOOLPROOF.

If you can count, you can create top notch projects with this tool in your shop. You can adjust your router bit in increments as small as 1/64". No time consuming set ups, tedious measuring, or clumsy jigs.

THE ADVANTAGE OF THE RouterSHOP KEY FUNCTIONS.

In just a few square feet of space, you get ALL THE KEY functions that are normally done by individual machines, which are explained on the next page.

NO NEED TO PURCHASE NUMEROUS HIGH COST BITS.

With a single spiral bit (included) you can create the seven most used joints in furniture and cabinet making. Rail, Stile, Raised Panel, Mortises, Tenons, and Tongue and Groove.

RUN YOUR ROUTER BIT AT ITS OPTIMAL POSITION.

The RouterShop gives you the versatility to position your router bit vertically, horizontally or any angle in between.

THE MOST ACCURATE WAY TO USE A ROUTER.

Instead of trying to balance your work piece against a flimsy fence you will be able to let your project rest flat on the table while the cutter changes position.

KEY WOODWORKING FUCTIONS OF THE RouterSHOP

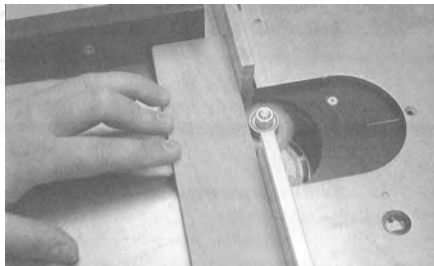
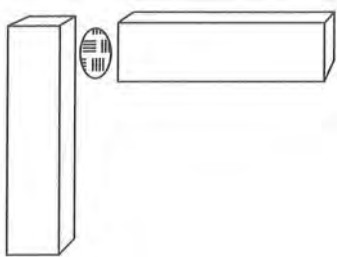

DOWEL/BISCUIT

By using the **RouterSHOP** as a boring machine with the table at 90° with a straight bit, you can use dowel pins in every glue joint. Using our stops you will create matching dowel pin sockets every time. You can also cut biscuit joints by setting the table flat and using a biscuit cutting bit, by using the same procedures as for doweeling.

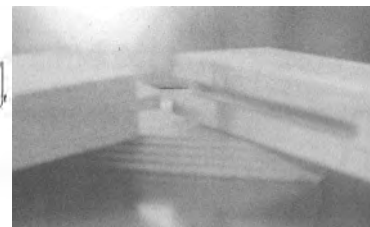
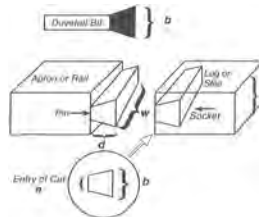

DOVE TAILING

Construct dovetail joints for drawer construction and traditional drawer slides. With the **RouterSHOP** you will construct perfect dove tails every time. Make beveled dovetails by tilting the table. Make locking corners by using both straight and beveled dove tails.

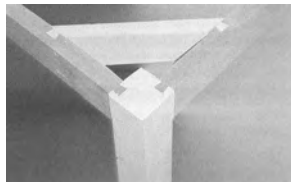
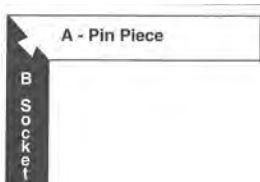

EDGE JOINTING

Joint clean flat edges on your work pieces, or create a tongue and groove joint with one spiral router bit. Perfect for preparing lumber for gluing up multiple pieces to create a panel.

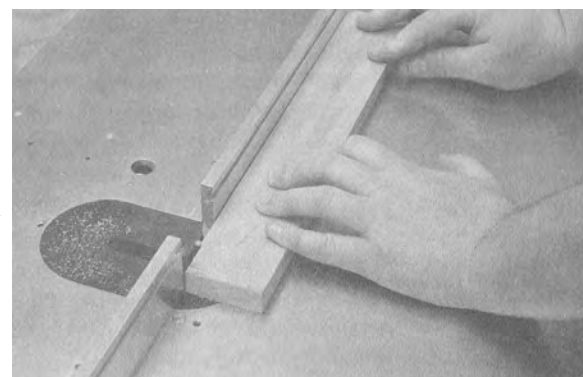
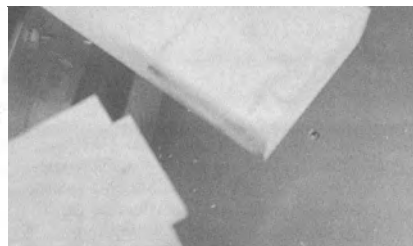
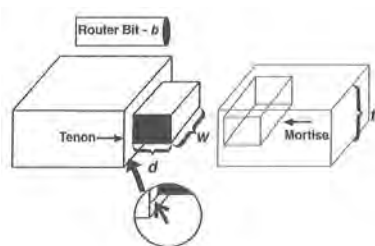

MORTISE AND TENONING

The mortise and tenon is one of the most attractive and strongest joints for case construction. Put an end to tedious frame sanding, you will get perfectly matched joints every time. Setting your cutter in the horizontal position makes these cuts nearly foolproof.

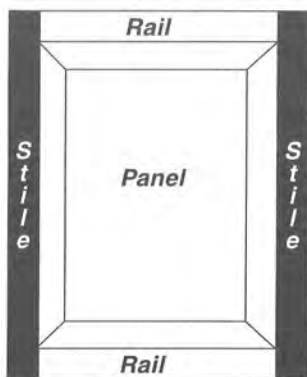

RAISED PANEL DOOR MAKING

The **RouterSHOP** gives you a foolproof way to create all three parts of a door, the rail, the stile and the raised panel. You can create all this with a single spiral router bit (included) by using multiple passes and the patented tilt table feature; or in a single pass by using stile, rail, and vertical raised panel router bits.

To make a raised panel door you have to cut a tongue and groove, cut the molding shape in the stile and rail, cut the end of the rail, and cut the raised panel. You can make all of these cuts in several passes with just a straight bit or you can buy special bits to do it in fewer passes but spend more on bits.

TONGUE AND GROOVE

The tongue and groove joint is easy to make. This joint is similar to making a mortise and tenon joint.

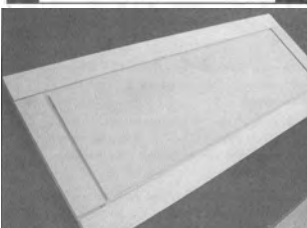
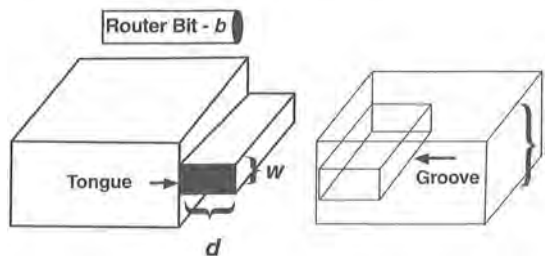

RAISED PANEL

Cutting of the raised panel can be done by using just one straight bit and making several cuts to obtain the shape, by using a few bits and multiple passes to yield a more detailed shape, or by using vertical raised panel router bit and using just one pass. It is your choice how much you spend on router bits.

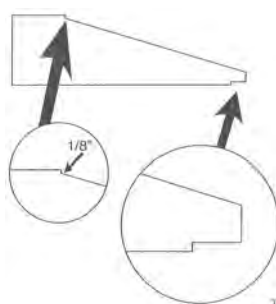

MOLDING

Create your own custom molding profiles. With a few standard router bits, such as straight, rounded and pointed bits, you can create endless one-of-a-kind custom molding profiles by using the patented tilting table feature.

SHAPING

Use standard decorative profile router bits to create hundreds of unique edge profiles on your projects. It is the perfect way to add your own unique touch to every project you build. There is no need to buy expensive router bits for shaping.



THE REPEATABILITY ADVANTAGE

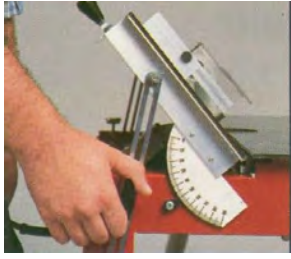

The split table design gives you the option of running the bit horizontal, vertical or any angle in-between. The handy Vernier gauge makes it easy to see the exact angle of the table for 0 to 90°.

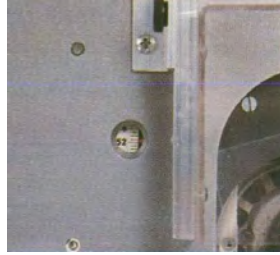

It is easy to keep track and record your cutter position with the cross feed scale and the position of cross feed screw.

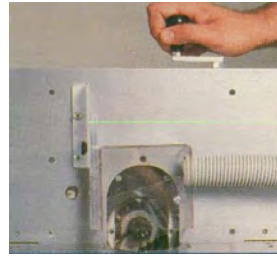

The unique design of the **RouterSHOP** gives you control of the cutter movement by turning the cross feed control screw.

To make the same cut over and over again, all you have to do is keep records. These few numbers are:

1. The router bit height.
2. The tilt table angle.
3. The cross feed number.
4. The cross feed screw crank position.

Record this information along with the router bit used and the wood thickness and you can reset and repeat the cut over and over whenever you need to.

SPECIFICATIONS

Overall	Height	40"
	Width	28"
	Length	34"
Shipping	Weight	96#
	Dimensions	38 x 29 x 7
Table Size	Overall	20 1/4" by 30 1/2"
	Stationary	11" by 30 1/2"
	Tilt	8 3/4" by 30 1/2"
Table Tilt Angle Range		0° to 90°
Table Construction		Magnetic Stainless Steel
Fence	Length	30 1/2"
	Stop Type	Thumb Screw
	Stop Number	2
Sliding Miter	Angle Range	-70° to 70°
	Travel Length	24"
	Stop Type	Thumb Screw
	Stop Number	2
Router	Type	Any 2 Hp or Larger
Router Slider	Travel Length	5"
	Scale Reading	1/16"
	Crank	1/16" per Turn 12 Marks per Turn.
Stand	Construction	14 Gauge Steel
	Shelf Number	2
Feather Boards	Number	2
	Mount Type	Sliding Thumb Screw
	Magnetic Mount	Optional
Push Stick		11"
Push Block		3" by 6"
Dust Collection	Hose Size	1"
	Hose Connection Size	2"
	Vacuum Rec.	Any Canister Vacuum
Router Bit Gauge Depth	Range	1/8" to 1"
	Increment	1/16"
Lubrication	Slides	Dri-Tool Lube
	Hinges	Dri-Tool Lube
	Bit	Router Bit Lube
Table Maintenance		Top-Saver or T-9

INCLUDES

Free Hand Pins	Miter Gauge	Miter Stop
Dust Collection System	Feather Boards	Push Stick
Push Block	Assembly Manual	
Operators Manual	Router Bit Gauge	

ACCESSORIES

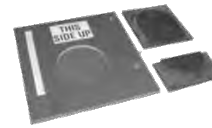

765-0510	Carriage Plate	\$35.00
765-2505	Zero Clearance Insert small	\$ 7.95



765-2500	Zero Clearance Insert large	\$14.95
----------	-----------------------------	---------

940-9551	Caster Kit	\$45.00
----------	------------	---------



865-0122	Router Speed Controller	\$39.00
----------	-------------------------	---------

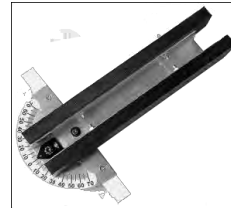

965-0057	Miter Gauge & Glide Track	\$79.00
----------	---------------------------	---------



940-0075	Fence Stop	\$9.95
940-0058	Miter Stops	\$9.95
765-0215	Feather Board	\$9.95



865-0221	Push Stick	\$5.95
865-0972	Push Block	\$5.95
865-0222	V-Push Stick	\$5.95



865-0980	Router Depth Gauge	\$13.95
----------	--------------------	---------



940-0085	Shop Vac Dust Collection Kit	\$39.00
950-0055	Fence Set	\$75.00
629-0120	Replacement precision hinges each	\$7.50
865-0600	.26ø Space Balls (50ct)	\$2.00



950-0000 JA36 FOR \$215.00
 950-0001 JA60 FOR \$250.00
 950-0002 JA96 FOR \$325.00

The **JointABILITY** is a matching edge jointer that lets you create flush and flat edge joints on every project. Eliminate the chatter, tear-out, and sniping every woodworker faces with traditional jointers and table saws. Using a patented technique, the **JointABILITY** gives you the expertise to create perfect fitting 90 degree matched edges using your router.

FEATURES

EASY GRIP CLAMPING MECHANISM

Handles stock up to 2" thick with nylon bushings for easy release.

URETHENE MAT

To hold your work piece securely in place.

EASY TO USE

If you can run a router and circular saw you can cut a straighter line than with a table saw or jointer. Your work piece clamped in place, you move a router not try to hold a long board on a jointer or table saw.

AFFORDABLE

For a fraction of the cost of a jointer or table saw, you can true an edge for gluing or cut straight lines for any size you need.

THREE SIZES

There are three sizes to choose from. The 36" JA36, the 60" JA60 or the 96" JA96 give you the size you need.

WIDE STOCK SIZE RANGE

Handles stock from 2" to an infinite width.

PORTABLE

At 30 pounds for the JA36, 54 pounds for the JA60 and 69 pounds for the JA96, it weighs far less than a jointer or table saw making it far more portable than a table saw or jointer.

EASY TO STORE

It stores in less than one square foot of space, by placing it on its end. Whether you stand it in the corner or hang it on the wall, it takes less than one square foot of space.

STEEL CONSTRUCTION

For a lifetime of reliable service.

ROUTER

You can use any router you own. You will be pleased with the accuracy of the cut.

DOUBLE LAMINATED MELAMINE

For a work surface that stays flat.

NO SPECIAL STAND NEEDED

Use any work bench or saw horses.

MADE IN THE USA

SAW GUIDE PLATE, ROUTER HOLSTER/
ATTACHMENT PLATE AND ¾" DIAMETER BY
1 ½" LONG ROUTER BIT ARE INCLUDED

ROUTER, SAW AND SAW HORSES
ARE NOT INCLUDED

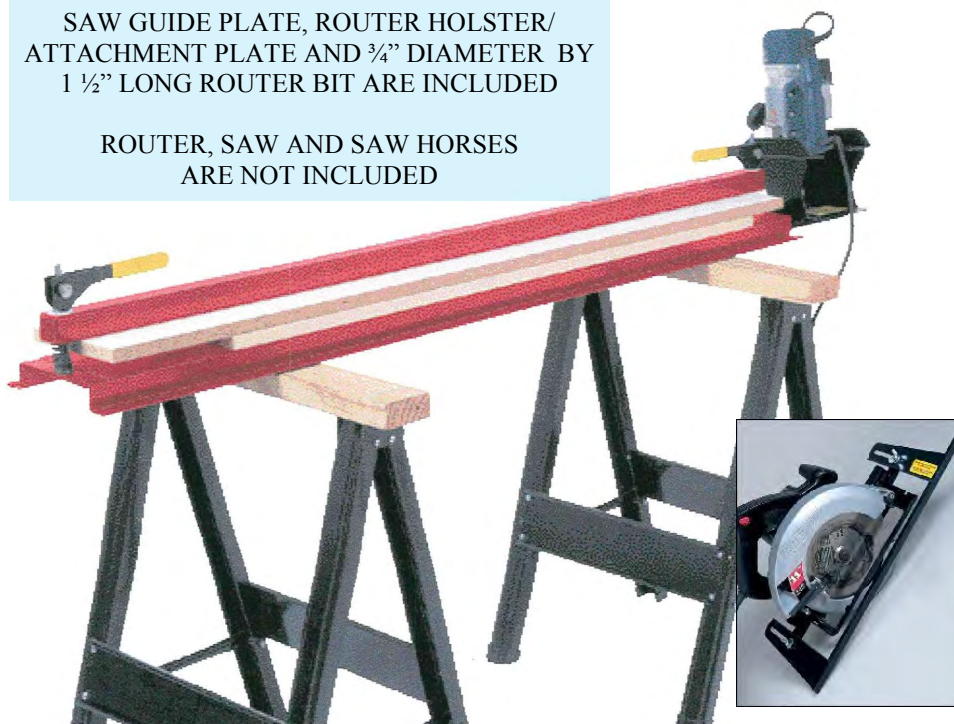

ADVANTAGES

Anything up to 8 feet long you can do with a jointer or table saw you can do with the **JointABILITY**.

True a rough edge in just 2 passes maximum instead of many passes with a jointer.

Save space. You only need 9 feet of length not the 16+ feet you would need with a jointer. When you are finished just hang the **JointABILITY** on the wall and free up your shop floor space.

Cut and Rip sheets in the space of the sheet while moving the router or circular saw not the whole sheet.

Save money over a table saw and or router.

Cuts the joint in the top of a board where you can see what you are doing, instead of on the bottom like when using a shaper table or router table.

With its lightweight design, you can take it to the job site easily; no need for help or a forklift to place it in and out of your truck.

SPECIFICATIONS

	JA36	JA60	JA96
Max length of stock	36"	60"	96"
Min length of stock	NONE	none	none
Max thickness of stock	2"	2"	2"
Min thickness of stock	none	none	none
Max width of stock	infinite	infinite	infinite
Min width of stock	2"	2"	2"
Weight		37 lbs	68 lbs
Overall length	39 ¼"	63 ¼"	99 ¼"
Overall length w/router holster	48 ¼"	72 ¼"	108 ¼"

CUT A TRUE BOARD OUT OF A ROUGH SLAB.

You can take a rough cut slab and make a board out of it.



Use the **JointABILITY** to make a cut on each side.



And have a finished board.



USES OF THE **HAWK** JointABILITY



With the **JointABILITY**, a dado or rabbet is cut with the right side up (not upside down as with a table saw) allowing you to see the results.

Use your circular saw with the **JointABILITY** to cut sheet to the desired size or to give a first cut on uncut edges of lumber before giving it a finish cut with your router.



Perfectly squared joints for gluing and you can square you glued up panels as well.

With the **JointABILITY**, the shape of your work piece does not matter. Just mark the project line on the stock and place it in the **JointABILITY**. Any place you can draw a straight line, you can cut a 90 degree face.



MAKES PERFECT JOINTS EVERY TIME.

Even Dado and Rabbet Joints.

For use with many solid materials like:

- Hardwoods
- Softwoods
- Plywood
- Particleboard
- Orientated strand board
- Veneers of all kinds
- Laminates
- Plastics

If you can cut in on your jointer or table saw you can cut in on the **JointABILITY**

OPERATING THE **HAWK** JointABILITY

THE KEY ADVANTAGE is that the **JointABILITY** is a matching edge jointer. That is you label the edges and the **JointABILITY** so the 2 sides of the joint are cut on the opposite sides of the **JointABILITY**. Then, even if there is any curvature of the joint it will match. We start with high grade steel tubing and then straighten it and finally clamp it in a fixture to holder it straight as it is fastened to the melamine substrate. Each step is to yield the straightest edge possible. If there is any bow to it, using the opposite side of the **JointABILITY** will give matching curves to your edges when you glue up.

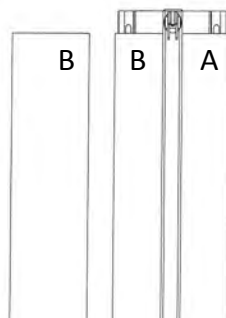
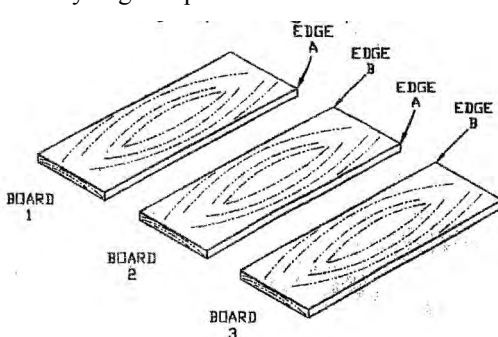

1. Lay out your boards matching both the grain and color. Label the edges such that an edge labeled A will match to an edge label B. Have your **JointABILITY** sides labeled A and B.
2. Trim each board using the label side of the **JointABILITY** that matches the label on the board. Note: do not flip the board end to end.
3. Check the fit of each joint.
4. Glue up the boards.

By using both sides of the **JointABILITY** the resulting matching joint will be nearly perfect. That is any curvature in one side of the joint will be matched by a corresponding curvature on the other side of the joint as can be seen in the figure to the side.

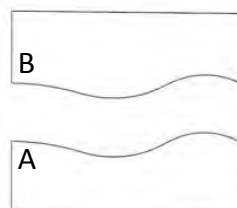

ACCESSORIES

We stock a variety of router bits to enable you to make the joint you want. Custom bits are also available. For best result using a circular saw always use high quality circular saw blades.

ROUTER HOLSTER

A router holster is available which can be attached to the end of the **JointABILITY**. This provides a safe place to put your router where you don't have to worry about the bit being damaged.

950-0003 ROUTER HOLSTER and ATTACHMENT \$59.95



SAW GUIDE PLATE

The saw guide plate allows for the proper location of the blade and gives more surface area for the saw to ride on, thus improving the quality of the cut.

950-0005 SAW GUIDE PLATE \$29.95



ROUTER BITS

We stock a variety of American Made router bits. With the RouterSHOP you only need standard shaped bits to create intricate patterns. Custom router bit holders and inserts are available.

SOLID CARBIDE SPIRAL BITS

Spiral bits combine effective chip removal with a continuous shearing action. Up-Cuts pull chips up to the router. Down-Cuts push chips away from the router.

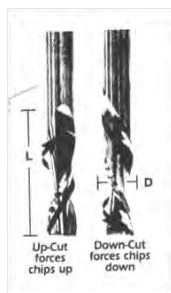

Hawk #	Description	Price
841-0002U	1/4 Dia, 3/4 Lg, 1/4 Shank, 2 1/2 OAL, 2 Flute, Spiral Upcut	\$17.05
841-0002D	1/4 Dia, 3/4 Lg, 1/4 Shank, 2 1/2 OAL, 2 Flute, Spiral Downcut	\$17.05
841-0003U	1/4 Dia, 1 Lg, 1/4 Shank, 2 1/2 OAL, 2 Flute, Spiral Upcut	\$18.00
841-0003D	1/4 Dia, 1 Lg, 1/4 Shank, 2 1/2 OAL, 2 Flute, Spiral Downcut	\$18.00
841-0006U	1/2 Dia, 1 Lg, 1/2 Shank, 3 OAL, 2 Flute, Spiral Upcut	\$44.60
841-0006D	1/2 Dia, 1 Lg, 1/2 Shank, 3 OAL, 2 Flute, Spiral Downcut	\$44.60
841-0007U	1/2 Dia, 1 1/2 Lg, 1/2 Shank, 3 OAL, 2 Flute, Spiral Upcut	\$47.45
841-0007D	1/2 Dia, 1 1/2 Lg, 1/2 Shank, 3 OAL, 2 Flute, Spiral Downcut	\$47.45
841-0008U	1/2 Dia, 2 Lg, 1/2 Shank, 4 OAL, 2 Flute, Spiral Upcut	\$51.25
841-0008D	1/2 Dia, 2 Lg, 1/2 Shank, 4 OAL, 2 Flute, Spiral Downcut	\$51.25

Hawk #	Description	Price
841-0040	1/2 Dia, 1 Lg, 1/2 Shank, 2 1/2 OAL, 2 Flute, Straight Plung Cut	\$16.45
841-0041	1/2 Dia, 1 1/2 Lg, 1/2 Shank, 3 1/8 OAL, 2 Flute, Straight Plung Cut	\$17.05
841-0042	1/2 Dia, 2 Lg, 1/2 Shank, 3 1/2 OAL, 2 Flute, Straight Plung Cut	\$19.90
841-0043	1/2 Dia, 2 1/2 Lg, 1/2 Shank, 4 3/8 OAL, 2 Flute, Straight Plung Cut	\$27.50
841-0050	3/4 Dia, 1 Lg, 1/2 Shank, 2 1/2 OAL, 2 Flute, Straight Plung Cut	\$18.00
841-0051	3/4 Dia, 1 1/2 Lg, 1/2 Shank, 3 OAL, 2 Flute, Straight Plung Cut	\$19.90
841-0052	3/4 Dia, 2 Lg, 1/2 Shank, 3 5/8 OAL, 2 Flute, Straight Plung Cut	\$25.60

PLUNGE CUTTING STRAIGHT BITS

These bits feature 2 flutes with extra thick micro-grain carbide cutting tips.

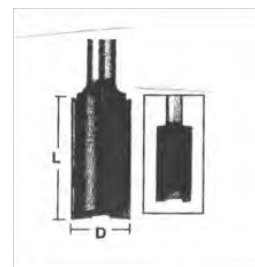

STANDARD INSERT ROUTER BIT KNIVES

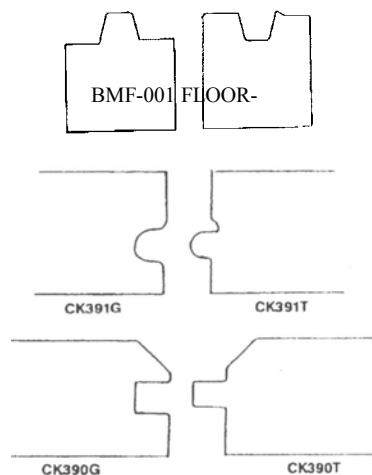
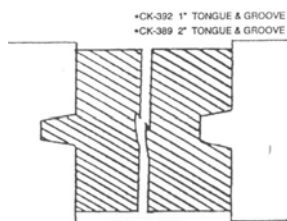

- 904-0200 Custom Router Bit
Holder 2 Screw
\$50.00
- 904-0201 Custom Router Bit
Holder 3 Screw
\$60.00
- 735-0007 1/2" Rub Bearing
\$11.50

Tongue and Groove #	Item #	Price per Set	Use Holder
CK-389 2" TONGUE	841-9100T	\$ 50.00	841-9001
CK-389 2" GROOVE	841-9100G	\$ 50.00	841-9001
CK-390 1" TONGUE	841-9101T	\$ 40.00	841-9000
CK-390 1" GROOVE	841-9101G	\$ 40.00	841-9000
CK-391 1" TONGUE	841-9102T	\$ 40.00	841-9000
CK-391 1" GROOVE	841-9102G	\$ 40.00	841-9000
CK-392 1" TONGUE	841-9103T	\$ 40.00	841-9000
CK-392 1" GROOVE	841-9103G	\$ 40.00	841-9000
BMF-001 FLOORING T	841-9104T	\$ 40.00	841-9000
BMF-001 FLOORING G	841-9104G	\$ 40.00	841-9000

MINI-STYLE AND RAIL BITS

Item #	Description	Price
841-0250	1/2 Shank, Roman Ogee Mini 2 piece Stile and Rail Set	\$123.45
841-0251	1/2 Shank, Round Mini 2 piece Stile and Rail Set	\$123.45

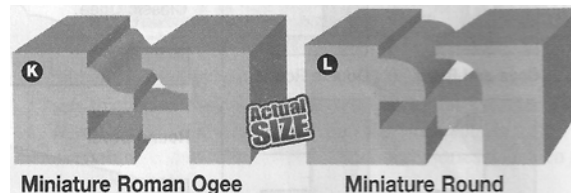

DOVE TAIL BITS

These two flute carbide tipped bits feature high radial and axial relief angles to give extra clean sharp edges.



Item #	Description	Price
841-0101	5/16 Dia, 8 Degree, 3/8 Lg, 1/4 Shank, 2 1/4 OAL, 2 Flute, Dove Tail	\$18.00
841-0102	3/8 Dia, 8 Degree, 1/2 Lg, 1/4 Shank, 2 3/8 OAL, 2 Flute, Dove Tail	\$18.00
841-0103	7/16 Dia, 8 Degree, 5/8 Lg, 1/4 Shank, 2 3/8 OAL, 2 Flute, Dove Tail	\$18.95
841-0104	1/2 Dia, 8 Degree, 13/16 Lg, 1/4 Shank, 2 3/4 OAL, 2 Flute, Dove Tail	\$18.95
841-0110	3/8 Dia, 14 Degree, 3/8 Lg, 1/4 Shank, 2 OAL, 2 Flute, Dove Tail	\$18.00
841-0111	1/2 Dia, 14 Degree, 1/2 Lg, 1/2 Shank, 2 1/2 OAL, 2 Flute, Dove Tail	\$18.95
841-0113	3/4 Dia, 14 Degree, 3/4 Lg, 1/2 Shank, 3 OAL, 2 Flute, Dove Tail	\$19.90
841-0114	1 Dia, 14 Degree, 7/8 Lg, 1/2 Shank, 2 1/2 OAL, 2 Flute, Dove Tail	\$28.45

ROUNDROVER AND BEADING BITS

Bits include a 1/2" rub bearing. They are converted to beading bits by replacing the 1/2" bearing with a 3/8" bearing. All bits are 2 flute carbide tipped.

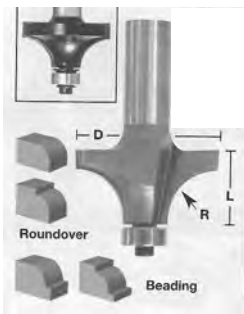

Item #	Description	Price
841-0081	1/8" rad, 3/4" dia, 1/2" Lg, 2" OAL, 1/4" Shank	\$18.95
841-0082	1/4" rad, 1" dia, 1/2" Lg, 2" OAL, 1/4" Shank	\$19.90
841-0083	3/8" rad, 1-1/4" dia, 5/8" Lg, 2-1/16 OAL, 1/4" Shank	\$20.85
841-0084	1/2" rad, 1-1/2" dia, 3/4" Lg, 2-1/2 OAL, 1/2" Shank	\$27.50
841-0085	5/8" rad, 1-3/4" dia, 7/8" Lg, 2-3/4" OAL, 1/2" Shank	\$41.75
841-0086	3/4" rad, 2" dia, 1" Lg, 3-1/4" OAL, 1/2" Shank	\$45.55
841-0080	3/8" bearing conversion includes allen wrench	\$4.95

VERTICAL RAISED PANEL CARBIDE

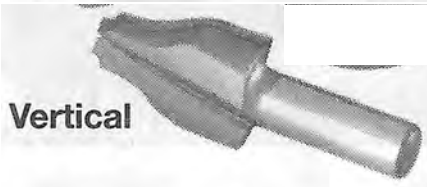
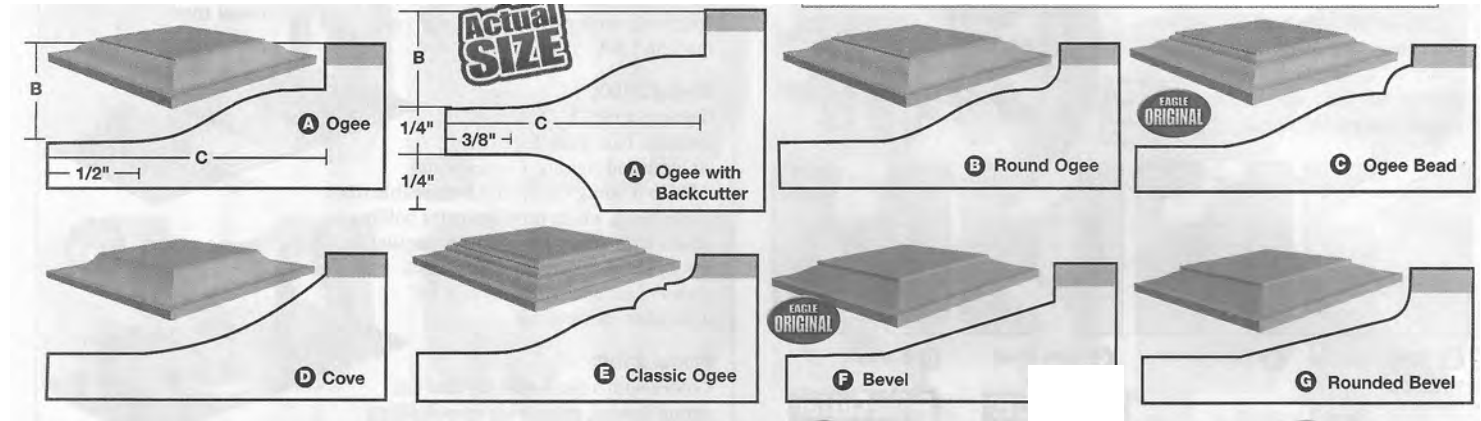

Vertical

Item #	Description	Price
841-0200	B= 1/2, C=1 1/2, 1/2 Shank, Ogee Style Vertical Raised Panel	\$56.95
841-0201	B= 1/2, C=1 1/2, 1/2 Shank, Round Ogee Style Vertical Raised Panel	\$56.95
841-0202	B= 1/2, C=1 1/2, 1/2 Shank, Ogee Bead Style Vertical Raised Panel	\$56.95
841-0203	B= 1/2, C=1 1/2, 1/2 Shank, Cove Style Vertical Raised Panel	\$56.95
841-0204	B= 1/2, C=1 1/2, 1/2 Shank, Bevel Style Vertical Raised Panel	\$56.95
841-0205	B= 1/2, C=1 1/2, 1/2 Shank, Rounded Bevel Style Vertical Raised Panel	\$56.95

STYLE AND RAIL BITS

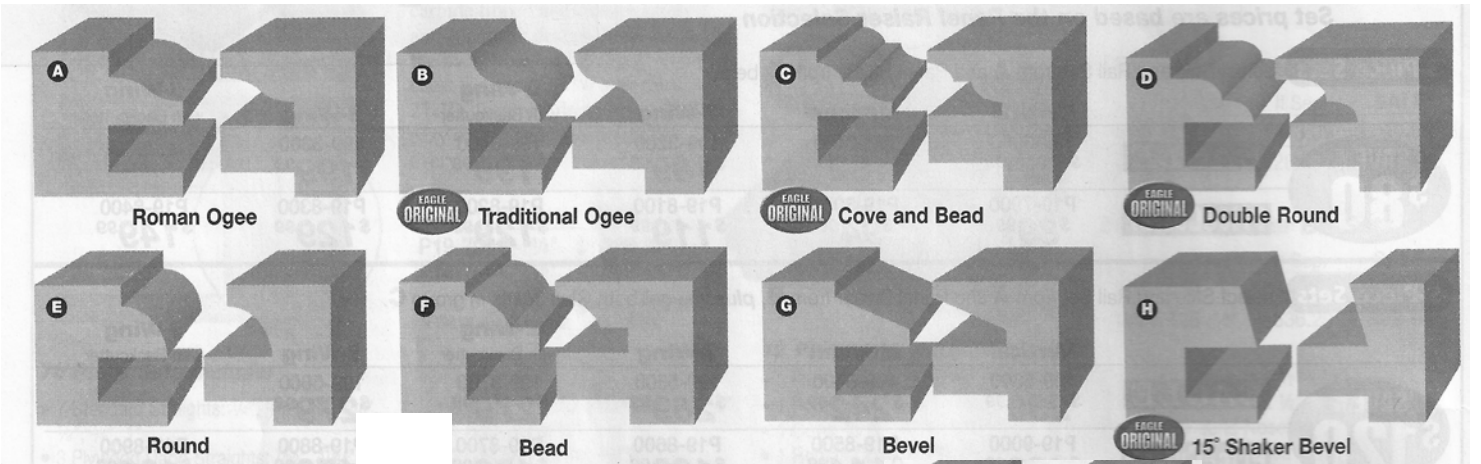

Item #	Description	Price
841-0240	1/2 Shank, Roman Ogee 2 piece Stile and Rail Set	\$104.45
841-0241	1/2 Shank, Traditional Ogee 2 piece Stile and Rail Set	\$104.45
841-0242	1/2 Shank, Cove and Bead 2 piece Stile and Rail Set	\$104.45
841-0243	1/2 Shank, Double Round 2 piece Stile and Rail Set	\$132.95
841-0244	1/2 Shank, Round 2 piece Stile and Rail Set	\$104.45
841-0245	1/2 Shank, Bead 2 piece Stile and Rail Set	\$104.45
841-0246	1/2 Shank, Bevel 2 piece Stile and Rail Set	\$104.45
841-0247	1/2 Shank, 15 Degree Shaker Bevel 2 piece Stile and Rail Set	\$123.45
841-0248	1/2 Shank, Cove 2 piece Style and Rail Set	\$116.80
841-0249	1/2 Shank, Southwestern 2 piece Style and Rail Set	\$116.80

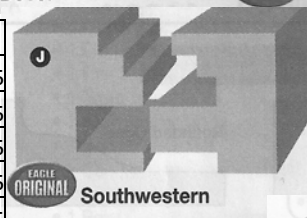

Southwestern

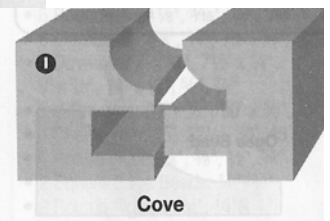

Cove



BUSHTON MANUFACTURING
HAWK
Woodworking Tools

USE THE CORRECT
BLADE TO DO YOUR JOB. WE
SELL 18 TYPES OF BLADES FROM 4
MANUFACTURERS IN UP TO 7 SIZES TO
MEET YOUR BLADE NEEDS



BUSHTON MANUFACTURING SCROLL SAW BLADE CHART

Olson Blades, Flying Dutchman Blades, Pike & Pegus Blades and Diamond Blades

Recommended = R
Usuable = U

OLSON Scroll Saw Blades

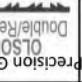
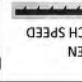
Size	Item #	Price/dozen	Price/gross	Pattern Type	Teeth/inch	# rev teeth	Width	Blade Thick.	Pilot Hole
Skip-tooth blades are excellent for fast cutting that provide smooth finishes and good chip clearance. #5 and smaller can be used for cutting soft metals less than 1/8" thick.	2/0 866-7000	\$2.50	\$23.00	Intricate	28	none	.022"	.010"	#71
	2 866-7002	\$2.50	\$23.00	Intricate	20	none	.029"	.012"	#68
	5 866-7005	\$2.50	\$23.00	Average	12.5	none	.038"	.016"	#59
	7 866-7007	\$2.50	\$23.00	Average	11.5	none	.045"	.017"	#55
	9 866-7009	\$2.50	\$23.00	Simple	11.5	none	.053"	.018"	1/16"
	12 866-7012	\$2.50	\$23.00	Simple	9.5	none	.062"	.024"	5/64"
Reverse tooth blades have skip style teeth and reverse teeth that eliminate underside tearout and provide a smooth splinter-free finish.	2/0 866-7100	\$2.80	\$25.00	Intricate	28	21	.026"	.011"	#69
	2 866-7102	\$2.80	\$25.00	Intricate	20	14	.029"	.012"	#65
	5 866-7105	\$2.80	\$25.00	Average	12.5	9	.038"	.016"	#57
	7 866-7107	\$2.80	\$25.00	Average	11.5	8	.045"	.017"	#55
	9 866-7109	\$2.80	\$25.00	Simple	11.5	8	.054"	.019"	1/16"
	12 866-7112	\$2.80	\$25.00	Simple	9.5	6	.062"	.024"	5/64"
Double tooth blades have 2 teeth together followed by a flat space for effective chip removal. They cut fast, leaving clean edges in wood and plastic.	2/0 866-7200	\$2.50	\$23.00	Intricate	37	none	.024"	.011"	1/32"
	3 866-7203	\$2.50	\$23.00	Detailed	23	none	.032"	.014"	#63
	5 866-7205	\$2.50	\$23.00	Average	16	none	.038"	.016"	3/64"
	7 866-7207	\$2.50	\$23.00	Average	13	none	.044"	.018"	#55
	9 866-7209	\$2.50	\$23.00	Simple	11	none	.053"	.018"	1/16"
	12 866-7212	\$2.50	\$23.00	Simple	10	none	.061"	.022"	5/64"
Spiral blades saw in all directions with 360 degree cutting capability. Excellent for 0 degree radius scroll/fret work - no need to turn the workpiece. Bevel cut letters and numbers.	2/0 866-7420	\$3.00	\$32.00	Intricate	51	none	.030"	.030"	3/64"
	0 866-7400	\$3.00	\$32.00	Detailed	46	none	.032"	.034"	3/64"
	2 866-7402	\$3.00	\$32.00	Average	41	none	.035"	.035"	5/64"
	2/0 866-7500	\$3.00	\$32.00	Intricate	20	every other	.024"	.011"	1/32"
	2 866-7502	\$3.00	\$32.00	Intricate	20	every other	.026"	.013"	#65
	5 866-7505	\$3.00	\$32.00	Detailed	16	every other	.038"	.016"	#56
This unique blade cuts on both the up and down strokes. Two-way cutting action provides a smooth splinter-less finish, and clean edges. When worn, the blade can be turned over for cutting with fresh set of teeth.	7 866-7507	\$3.00	\$32.00	Average	11	every other	.045"	.017"	#55
	9 866-7509	\$3.00	\$32.00	Simple	6	every other	.053"	.018"	1/16"
	12 866-7512	\$3.00	\$32.00	Simple	6	every other	.065"	.024"	5/64"
	0 866-7700	\$3.20	\$33.00	Soft Metals	48	none	.024"	.012"	#65
	2 866-7702	\$3.20	\$33.00	Soft Metals	43	none	.028"	.013"	#63
	5 866-7705	\$3.20	\$33.00	Soft Metals	36	none	.033"	.016"	#59
for cutting soft metals from thin mild steel to non-ferrous metals like aluminum, brass, copper etc.	7 866-7707	\$3.20	\$33.00	Soft Metals	30	none	.041"	.019"	#55
	9 866-7709	\$3.20	\$33.00	Soft Metals	25	none	.049"	.022"	1/16"
	12 866-7712	\$3.20	\$33.00	Soft Metals	20	none	.070"	.023"	5/64"
	0 866-7900	\$3.90	\$39.00	Average	12	9	.044"	.018"	#55
	7 866-7307	\$3.90	\$39.00	Average	10	7	.046"	.018"	#55
	9 866-7309	\$3.90	\$39.00	Average	8	6	.048"	.018"	1/16"
PGT blades have razor sharp teeth with widely spaced gullets for cutting straighter, faster, smoother, more accurately. PGT's minimize burning and provide the ultimate sanding free, splinter-less finish with a clean edge.	2/0 866-7200	\$2.50	\$23.00	Intricate	37	none	.024"	.011"	1/32"
	3 866-7203	\$2.50	\$23.00	Detailed	23	none	.032"	.014"	#63
	5 866-7205	\$2.50	\$23.00	Average	16	none	.038"	.016"	3/64"
	7 866-7207	\$2.50	\$23.00	Average	13	none	.044"	.018"	#55
	9 866-7209	\$2.50	\$23.00	Simple	11	none	.053"	.018"	1/16"
	12 866-7212	\$2.50	\$23.00	Simple	10	none	.061"	.022"	5/64"

	5	866-7605	\$3.90	\$39.00	Average	12	8	.045"	.018"	#55	U	R	R	U	U	U	U	X	X
	7	866-7607	\$3.90	\$39.00	Average	10.5	8	.047"	.018"	1/16"	R	U	R	U	R	R	U	X	X
	9	866-7609	\$3.90	\$39.00	Average	9	6	.049"	.018"	1/16"	R	U	R	U	R	R	U	X	X
	Size	Item #	Price/dozen	Price/gross	Pattern Type	Teeth/inch	# rev teeth	Width	Blade Thick.	Pilot Hole									
	3	866-7803	\$3.00	\$32.00	Intricate	13	7	0.032	0.014	#57	U	R	R	U	U	R	U	X	X
	5	866-7805	\$3.00	\$32.00	Average	13	7	0.038	0.016	#56	U	R	R	U	U	R	U	X	X
	7	866-7807	\$3.00	\$32.00	Average	8	6	0.046	0.017	#55	R	U	R	U	R	R	U	X	X
	9	866-7809	\$3.00	\$32.00	Average	8	6	0.055	0.018	5/64"	R	U	R	U	R	R	U	X	X
	Size	Item #	Price/each	Price/dozen	Pattern Type	Teeth/inch		Width	Blade Thick.	Pilot Hole									
	~	866-7910	\$2.00	\$22.00	All	~		0.156"	.056"	~	R	R	R	R	U	U	U	R	X

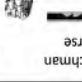
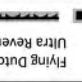
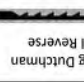
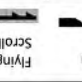
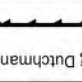
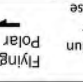
Staying Dutchman Scroll Saw Blades																			
	Size	Item #	Price/dozen	Price/gross	Pattern Type	Teeth/inch	# rev teeth	Width	Blade Thick.	Pilot Hole									
	1	866-6001	\$3.20	\$29.50	Intricate	15	every 3rd	0.029	0.011	#68		R	R		U	R			X
	3	866-6003	\$3.20	\$29.50	Detail	15	every 3rd	0.013	0.013	#65		R	U	U	U	R			X
	5	866-6005	\$3.20	\$29.50	Detail	15	every 3rd	0.037	0.015	#63	U	U	U	U	U	U	R		X
	Size	Item #	Price/dozen	Price/gross	Pattern Type	Teeth/inch	# rev teeth	Width	Blade Thick.	Pilot Hole									
	1	866-6021	\$2.90	\$27.50	Intricate	13	7	0.026	0.011	#68		R	R						X
	3	866-6023	\$2.90	\$27.50	Detail	13	7	0.035	0.013	#65		R							X
	5	866-6025	\$2.90	\$27.50	Detail	13	7	0.037	0.015	#63	U	R	U	U	U				X
	7	866-6027	\$2.90	\$27.50	Average	10	7	0.043	0.017	#57	R	U	U	R	R				X
	Size	Item #	Price/dozen	Price/gross	Pattern Type	Teeth/inch	# rev teeth	Width	Blade Thick.	Pilot Hole									
	2/0	866-6040	\$2.95	\$27.50	Intricate	30.5	none	0.023	0.010	#71					R	R	R		X
	1	866-6041	\$2.95	\$27.50	Intricate	28	none	0.026	0.011	#68					R	R	R		X
	3	866-6043	\$2.95	\$27.50	Detail	24	none	0.031	0.013	#65					R	R	R		X
	5	866-6045	\$2.95	\$27.50	Detail	17	none	0.037	0.015	#63					R	R	R		X
	7	866-6047	\$2.95	\$27.50	Average	15	none	0.043	0.017	#57					R	R	R		X
	Size	Item #	Price/dozen	Price/gross	Pattern Type	Teeth/inch	# rev teeth	Width	Blade Thick.	Pilot Hole									
	5	866-6105	\$2.75	\$26.50	Detail	18	8	0.037	0.015	#63	U	U	R	U	U	U			X
	Size	Item #	Price/dozen	Price/gross	Pattern Type	Teeth/inch	# rev teeth	Width	Blade Dia	Pilot Hole									
	2/0	866-6140	\$3.55	\$34.00	Intricate	35	none		0.027	#65		R	R						X
	1	866-6141	\$3.55	\$34.00	Intricate	27	none		0.030	#63		R	R		U	U			X
	3	866-6143	\$3.55	\$34.00	Detail	27	none		0.035	#59	R	R	R	U	U	U			X
	5	866-6145	\$3.55	\$34.00	Detail	27	none		0.037	#56	R	R	R	U	U	U			X
	Size	Item #	Price/dozen	Price/gross	Pattern Type	Teeth/inch	# rev teeth	Width	Blade Thick.	Pilot Hole									
	~	866-6240	\$2.80	\$27.50	Very Intricate	31	none	0.015	0.008	#71		R							X

Pegus and Pike Brand Saw Blades

	Size	Item #	Price/dozen	Price/gross	Pattern Type	Teeth/inch	# rev teeth	Width	Blade Thick.	Pilot Hole									
	8/0	866-5000	\$4.10	\$40.00	Very Intricate	96	none	0.013	0.006	#77						U	R		X
	6/0	866-5002	\$4.10	\$40.00	Very Intricate	70	none	0.016	0.008	#76						U	R		X
	Size	Item #	Price/dozen	Price/gross	Pattern Type	Teeth/inch	# rev teeth	Width	Blade Thick.	Pilot Hole									
	3	866-5103	\$2.70	\$23.20	Detail	19	none	0.038	0.012	#63		R	U	U					X
	5	866-5105	\$2.70	\$23.20	Detail	16.5	none	0.043	0.015	#57	U	R	R	U	U				X
	7	866-5107	\$2.70	\$23.20	Average	15	none	0.05	0.015	#57	R	U	R	U	U				X
	9	866-5109	\$2.70	\$23.20	Average	13	none	0.055	0.016	1/16"	R	U	R	U	R				X
	Size	Item #	Price/dozen	Price/gross	Pattern Type	Teeth/inch	# rev teeth	Width	Blade Thick.	Pilot Hole									
	3	866-5403	\$3.80	\$33.30	Detail	13	7	0.035	0.013	#65						R	R	R	X
	5	866-5405	\$3.80	\$33.30	Detail	13	7	0.037	0.015	#63						R	R	R	X
	7	866-5407	\$3.80	\$33.30	Average	10	7	0.043	0.017	#57						R	R	R	X
	9	866-5409	\$3.80	\$33.30	Average	8	6	0.05	0.018	1/16"						R	R	R	X
	Size	Item #	Price/dozen	Price/gross	Pattern Type	Teeth/inch	# rev teeth	Width	Blade Thick.	Pilot Hole									
	6-1/2"	866-5900	\$4.00	\$40.00	Average														
	Size	Item #	Price/each	Price/dozen	Pattern Type	Teeth/inch	# rev teeth	Width	Blade dia.	Pilot Hole									
	1mm	866-7902	\$19.00		Average				1mm								R	R	X
	3/4mm	866-7903	\$18.00		Average				3/4mm								R	R	X

BishopCLAMP

by  **HAWK** Woodworking Tools™
Bushton Manufacturing • Bushton, KS

This clamping system developed by Homer Bishop is ideal for intarsia clamping as well as clamping of any shape. Its versatility allows you to clamp any shape you want. The BishopCLAMP system is made of HDPE which most glues will not adhere to.



The system includes:

- 1 base board 24" by 32"
- 10 side rail segments
- 1 center rail segment
- 10 4" ratchet bar clamp/spreader
- 4 weight bags

950-0300 INTRODUCTORY PRICE OF \$175
SHIPPING 33" x 24" x 2", weight 28#

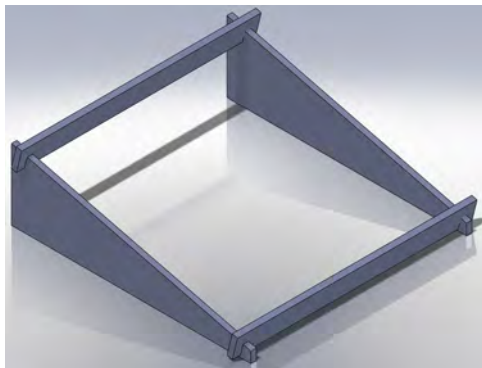

ACCESSORIES

950-0301	Inclined Stand	\$55.00
850-0100	4" Clamp/Spreader	\$4.00
750-0103	10" Short Rail	\$10.00
750-0105	22" Movable Rail	\$20.00
750-0115	Weight Bag	\$1.00

THE USES OF THE BishopCLAMP

If you need to clamp it, but it's not an easy shape to hold, then the **BishopCLAMP** will hold it for you. If you just need to inspect the fit, check the size, or hold it till the glue dries we have you covered. This clamping system was developed by Homer Bishop to be used for Intarsia projects. The clamping arrangement is so versatile that it can be used to clamp any shape. The **BishopCLAMP** can be used for clamping a multitude of regular and odd shaped items. This includes but is not limited to Fret, Intarsia, Stained Glass, Door Panels, Boxes, Picture Frames, Models, Carving and Router Pieces.

Now for a few samples of what the BishopCLAMP can help you hold.

An **Intarsia Wolf** without a single straight side.

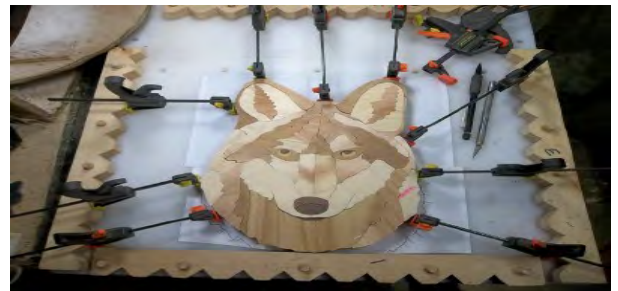

An **Fret Work Octagon Lamp** is held in the **BishopCLAMP**. You can see the 8 individual fret work sides being clamped to the top of the octagon star lamp. The finished project is also shown.



Here is a **lighted Butterflies** project shown.

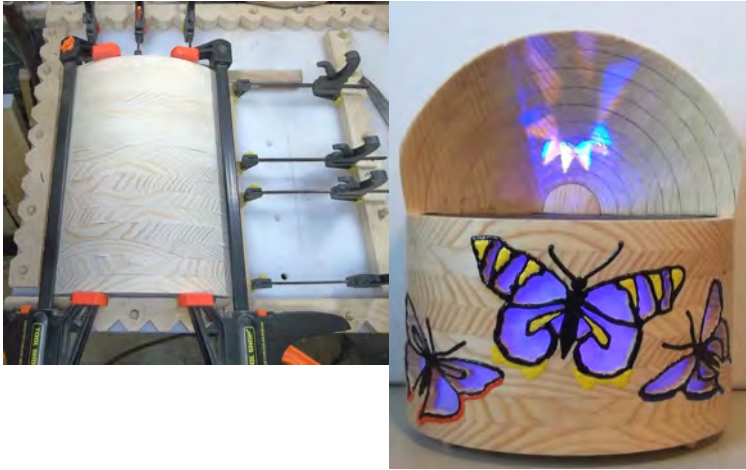

Cut and check the fit of internal pieces. The clamps will keep the model securely in place.



Continue to cut and clamp pieces in place to check the fit. You may need to change the blocking and how the clamps push on the project to hold it as needed.



Seen here is 3 steps in the **Up and Away** project.



Continue to add pieces and clamping as needed.



The picture is cut except for the sky piece and all the pieces are held in the proper place. Now is when the pieces would be sanded, shaped, raised or lowered and re-clamped as this is done. When this is done the pieces can be glued and held flat while the glue sets up. The weight bags can be placed on the project to hold every thing down flat.



FOR INTARSIA

We will use the 'The Good Life' pattern by Homer Bishop.

Start with a copy of the pattern and set the center rail where needed. The long rail (right rail) is adjustable.

Cut the three major bottom pieces and use blocking so the clamps will reach the project pieces. Clamps are used as spreaders to keep the project work area open.

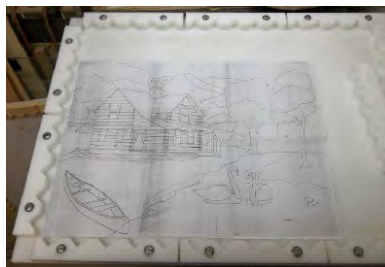

Use weight bag to help keep the picture straight.



The finished project 'The Good Life'





950-0200 for \$119.00

VerticalCLAMP a **HAWK** WOODWORKING TOOL

Big commercial shops and furniture builders have used vertical clamping systems for years to save shop floor space. Now you can save floor space with the **HAWK VerticalCLAMP** Vertical Clamping System.

Mounted on the wall of your garage, basement or workshop, you will have the perfect system for clamping glued up panels or doors. You will not tie up your work bench or have glue fall on to it. The system extends from the wall so that you can set each board on it, apply the glue and stack the next board. The boards are near flat when you apply the glue so you do not have the glue running off on the bench.

COMPARE PRICE AND ADVANTAGES

At a national lumber yard the price for a 4' 3/4 black nipple is \$12.38 and a 3/4" pipe clamp is \$14.98 which yields a total of \$122.12 for 4 clamps. **Our system costs less, hangs on the wall, and uses zinc plated pipes rather than black which will rust or galvanized which will slip** when you are clamping.

It is a simple 4 step process to glue up your boards and have them stored.



1. Load and glue up work piece.

2. Tighten clamps.

3. Flip stop to vertical position.

4. Let the panel dry.

CONTAINS

- 2) 2 by 4 by 4' Long
- 1) 1 by 10 by 4' Long

- 4) Hangers
- 1) Hanger Rail

- 4) 3/4 Zinc Plated T-Pipe
- 1) Bag of Mounting Hardware

- 2) Shelf Hinges

SPECIFICATIONS

Overall Length	4'
Clamp Pipe Length	4'
Number of Clamps	4
Additional Clamp w/Hanger	Optional
Shipping Dimensions	54 x 10 x 6, 54#

ACCESSORIES

950-0202	Clamp/T-Pipe/Hanger	\$26.50
950-0204	Rail/Hanger/Flip Shelf Hinge	\$45.00
For if you have your own clamps.		
Does not contain boards or mounting screws.		

For best results use the **HAWK OrthoCLAMP to clamp the faces of the boards flat when gluing up a panel with the **HAWK** VerticalCLAMP.**
This is show on the next page.

OrthoCLAMP

950-0400

\$35.00

by  **HAWK Woodworking Tools™**
Bushton Manufacturing • Bushton, KS

The **OrthoCLAMP** has an eight inch reach for holding the faces of glued up panels flat. It is designed to work well with the **VerticalCLAMP** to insure nearly perfect glued up panels even when your boards are not.



Use **OrthoCLAMP** with the **VerticalCLAMP** to make nearly perfect glued up panels.

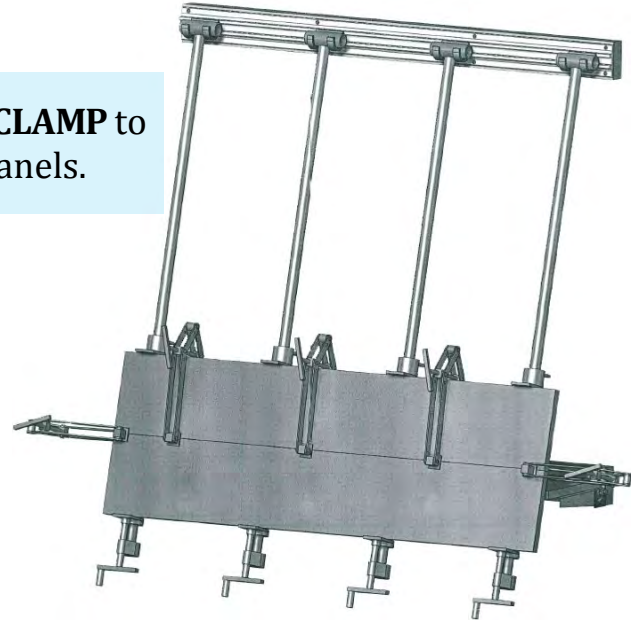

BushtonCLAMP

by  **HAWK Woodworking Tools™**
Bushton Manufacturing • Bushton, KS

The **BushtonCLAMP** is square and has a flat back that will not tip over on a table when you are gluing up boards. It has a positive lock system that will not slip like pipe clamps. The square shape of the **BushtonCLAMP** also makes it work well when gluing up frames and boxes.

Clamps are made of 1-5/8" by 10 gauge steel strut to sit square on the work bench when gluing up a panel. Heavy steel acme screw and clamp pads yield a clamp for your highest clamping force needs.



The design has a flat back so that it does not tip over on your work bench when you are doing a glue up.

The **HAWK BushtonCLAMP** has an easy to adjust sliding jaw. Just tilt it and you can slide it along the length of the clamp. A spring is used to lock it in place.

The sliding jaw is held in location by fitting into a slot in the back plate. As can be seen in the cut away of the clamp.



Item #	Description	Price
950-0502	2 Foot Long Strut Bar Clamp	\$30.00
950-0504	4 Foot Long Strut Bar Clamp	\$35.00
950-0506	6 Foot Long Strut Bar Clamp	\$40.00

PanelMASTER III

by **HAWK** Woodworking Tools™
Bushton Manufacturing • Bushton, KS

910-2022 \$3895.00

Order separately
Your choice of cutters,
rub collars for that set of cutters,
and crown rail jig along with the tem-
plates for the jig.

Make your own raised panel, glass panel or flat panel cabinet doors with one machine and all 3 cutter on the machine at all times. You can even make your own interior or exterior raised panel doors for you home.



FEATURES

HIGH SPEED BEARINGS are self-aligning for years of trouble free service.

PRECISION MACHINED ALUMINUM FENCES AND TABLE for extremely accurate shaping.

TABLE TILTS yielding reduced time to change blades.

PATENTED STILE JIG for accurate cuts and prevents blowout of the wood.

SAFETY JIG AND FENCE CONSTRUCTION for maximum operator safety even for the inexperienced.

ENCLOSED DRIVES and fully guarded cutters for maximum safety.

MANUAL FEED lets you operate at your own speed.

HEAVY DUTY V-BELT DRIVE delivers maximum power to the cutter head for all applications with a single belt.

INDUSTRIAL GRADE 5 HP MOTOR to give years of dependable service.

MAGNETIC SAFETY SWITCH IS STANDARD, this is required by OSHA for commercial applications.

HEAVY GAUGE STEEL BASE designed for years of demanding use.

MADE IN THE USA.

SPECIFICATIONS

Overall Width	22 1/4"	Feed Type	Manual
Overall Length	31 1/2"	Motor Horse Power	5 Hp
Overall Height	38"	Voltage	220 VAC
Table Length	30 1/2"	Phase	1 Ph or 3 Ph Optional
Number of Cutting Heads	3	Speed	3500 rpm
Maximum Diameter of Cutting Head	6"	Frame	184T
Cutter Bore	1 1/4"	Shipping Dimensions	
Cutting Speed	6800 rpm	Shipping Weight	

TILT TABLE

allow you to change and reset cutter easily in a short amount of time.



Make your own cabinet doors for your kitchen, bathroom, office, closet, den or any other room in your house. Make crown rail door with out any change to the machine settings. Use raised panel, flat panel or even glass panels in your doors. All in just a few minutes with out major machine set up changes or multiple machines.



PRECISION MACHINED TABLE AND FENCES yield accurate cuts every time

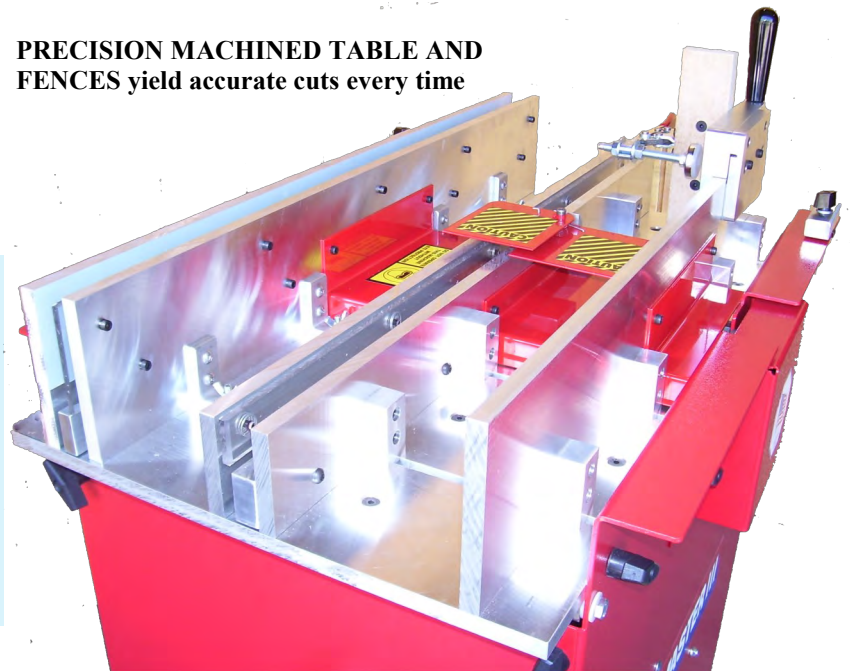

With the unique horizontal shaft design you have all three cutters for a raised panel door on the machine at the same time. No changing cutters or have 3 machine using more floor space. Less than 6 square feet of space is required.

Make a door in 2 minutes once you have the boards cut to size.

ALTERNATE BETWEEN THE RAISED PANEL, STYLE AND RAIL CUTS without changing any settings

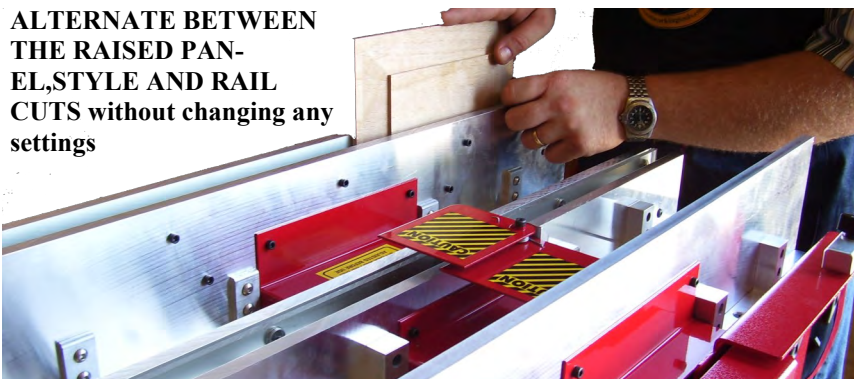

Cutters down between a pair of fences is safer than a standard vertical shaft shaper table.

CREATE RAISED PANEL DOORS IN LESS THAN 2 MINUTES

If you are in the business of making custom cabinets or if you are remodeling a kitchen, no other tool on the market comes close to the **HAWK PanelMASTER III** when making custom cabinets.

- Cut a complete raised panel door, (stiles, rails, and raised center panel) in less than 2 minutes. All three cutters are on the machine at the same time.
- Make custom straight panel fast and easy, or make raise arched panels fast in a variety of styles with our crown rail jig or template sets (optional).
- 3 precision cutter heads cut the raised panel and makes all rail and stile cuts without changing cutters.
- Compact design requires only 6 square feet of floor space.
- Replace your old cabinets at a fraction of the cost of custom cabinets.
- Build raised panel interior and exterior doors.
- Make doors up to 1-3/4 inches thick.
- Make multiple panel doors.
- Make crown rail doors with out changing any settings
- Make your own templates and put your own style arch or crown on the door.

This tool can pay for itself the first time you use it. Plus, you will make custom paneled doors in a variety of styles faster and easier than you ever thought possible all with this one revolutionary machine. Designed for commercial use, this heavy-duty piece of equipment is constructed of steel and aluminum for safety and durability.



PanelMASTER III ACCESSORIES

Crown rail jig and templates.

Make arched panel doors easily and quickly with this crown rail jig made of machined aluminum. Ten durable pattern templates are available. Extremely easy and safe to use, simply rough saw crown rails to size, then use bearing rub collar to produce perfect results every time.

910-0100	Crown Rail Jig	\$350.00
910-0200	Crown Rail Template Set	\$199.00
690-0146	Stile Jig	\$199.00



MOBILE BASE

910-2500	Mobile Base	\$250.00
----------	-------------	----------

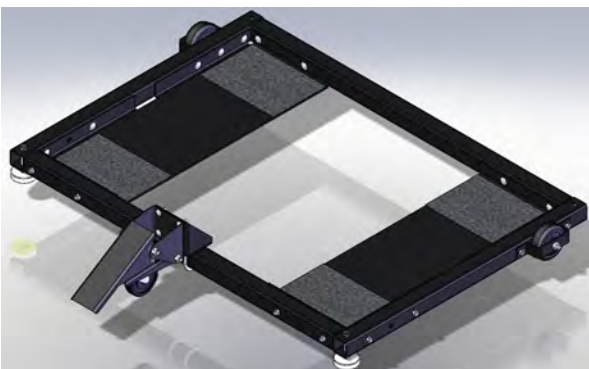

SPACE BALLS



RUB BEARINGS

810-0190	3" Rub Bearing	\$61.00
810-0191	3.25" Rub Bearing	\$61.00

ARBORS

690-0036	ARBOR NUT	\$16.00
690-0107	ARBOR	\$39.95
690-0108	ARBOR SPACER, 3/4" THK.	\$8.95
690-0109	ARBOR SPACER, 1/2" THK.	\$6..95
690-0104	ARBOR SPACER, .031 THK.	\$1.50
690-0103	ARBOR SPACER, .005 THK.	\$1.50
690-0111	ARBOR KEY 1/4" DIA	\$2.95

BEARINGS

790-0101	BEARING BLOCK 1"	\$45.00
----------	------------------	---------

SHAFT

690-2110	CUTTERHEAD SHAFT, PM3	\$89.95
----------	-----------------------	---------

WEAR TAPE

790-0140A	10 mil Wear Tape 1/4 wide	\$x.xx per foot
790-0140A	10 mil Wear Tape 2 wide	\$x.xx per foot
790-0140A	10 mil Wear Tape 3 wide	\$x.xx per foot
790-0140A	30 mil Wear Tape 3 wide	\$x.xx per foot

SPACE BALLS

8XX-XXXX	Space ball pack of 50	\$
----------	-----------------------	----

FREEBORN CUTTERS AND SETS

3/4" to 1-1/8" material

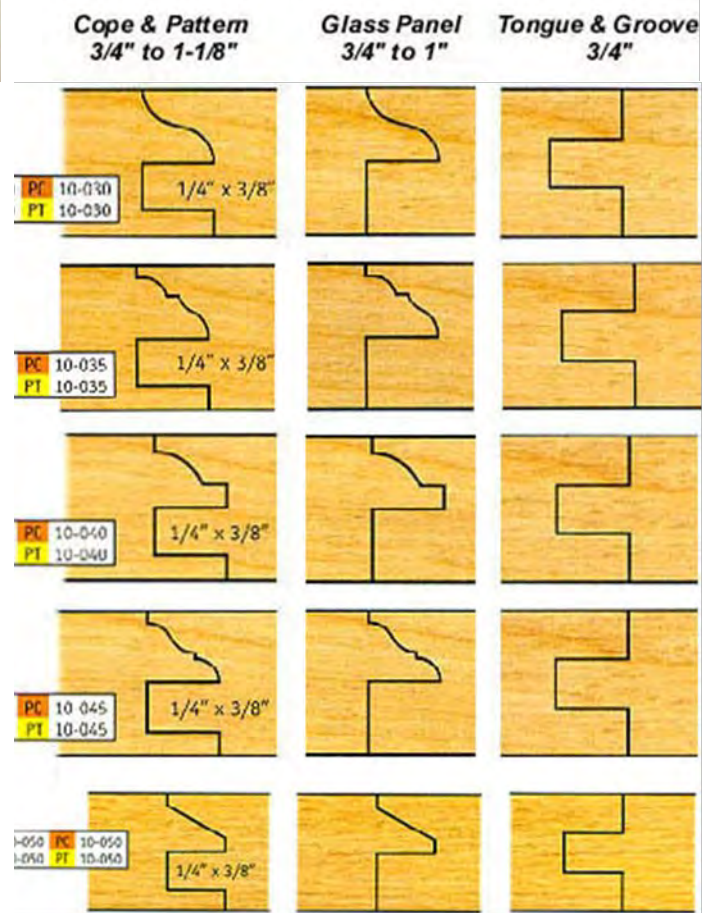
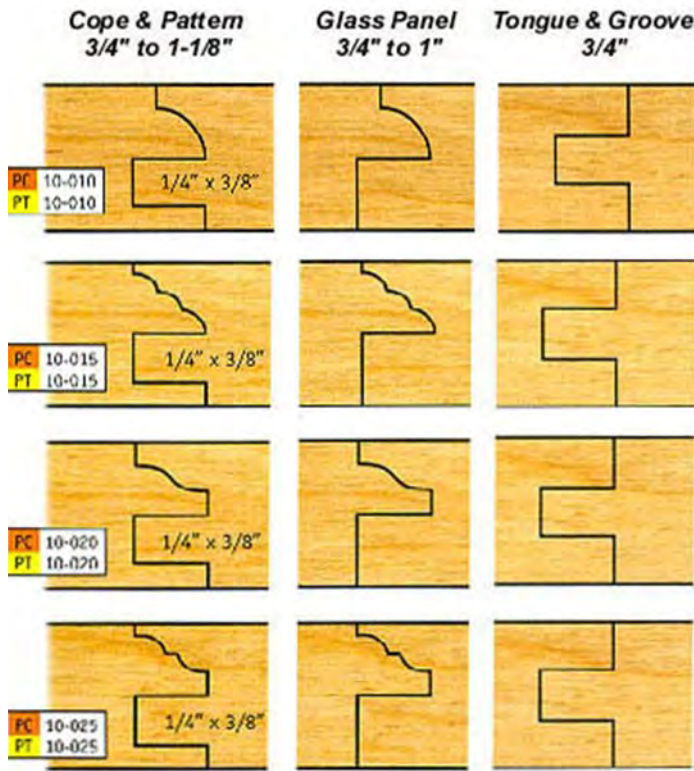

Item #	Freeborn	Cutter Set Type	Material	Price
810 10-010C	PC-10-010	COPE AND PATTERN SETS (6 CUTTERS)	CARBIDE	\$533.90
810 10-010T	PT-10-010	COPE AND PATTERN SETS (6 CUTTERS)	TANTUNG	\$587.10
810 10-015C	PC-10-015	COPE AND PATTERN SETS (6 CUTTERS)	CARBIDE	\$533.90
810 10-015T	PT-10-015	COPE AND PATTERN SETS (6 CUTTERS)	TANTUNG	\$587.10
810 10-020C	PC-10-020	COPE AND PATTERN SETS (6 CUTTERS)	CARBIDE	\$533.90
810 10-020T	PT-10-020	COPE AND PATTERN SETS (6 CUTTERS)	TANTUNG	\$587.10
810 10-025C	PC-10-025	COPE AND PATTERN SETS (6 CUTTERS)	CARBIDE	\$533.90
810 10-025T	PT-10-025	COPE AND PATTERN SETS (6 CUTTERS)	TANTUNG	\$587.10
810 10-030C	PC-10-030	COPE AND PATTERN SETS (6 CUTTERS)	CARBIDE	\$533.90
810 10-030T	PT-10-030	COPE AND PATTERN SETS (6 CUTTERS)	TANTUNG	\$587.10
810 10-035C	PC-10-035	COPE AND PATTERN SETS (6 CUTTERS)	CARBIDE	\$533.90
810 10-035T	PT-10-035	COPE AND PATTERN SETS (6 CUTTERS)	TANTUNG	\$587.10
810 10-040C	PC-10-040	COPE AND PATTERN SETS (6 CUTTERS)	CARBIDE	\$533.90
810 10-040T	PT-10-040	COPE AND PATTERN SETS (6 CUTTERS)	TANTUNG	\$587.10
810 10-045C	PC-10-045	COPE AND PATTERN SETS (6 CUTTERS)	CARBIDE	\$533.90
810 10-045T	PT-10-045	COPE AND PATTERN SETS (6 CUTTERS)	TANTUNG	\$587.10
810 10-050C	PC-10-050	COPE AND PATTERN SETS (6 CUTTERS)	CARBIDE	\$533.90
810 10-050T	PT-10-050	COPE AND PATTERN SETS (6 CUTTERS)	TANTUNG	\$587.10
810 10-060C	PC-10-060	COPE AND PATTERN SETS (6 CUTTERS)	CARBIDE	\$533.90
810 10-060T	PT-10-060	COPE AND PATTERN SETS (6 CUTTERS)	TANTUNG	\$587.10
810 10-070C	PC-10-070	COPE AND PATTERN SETS (6 CUTTERS)	CARBIDE	\$533.90
810 10-070T	PT-10-070	COPE AND PATTERN SETS (6 CUTTERS)	TANTUNG	\$587.10

7/8" to 1-1/8" material

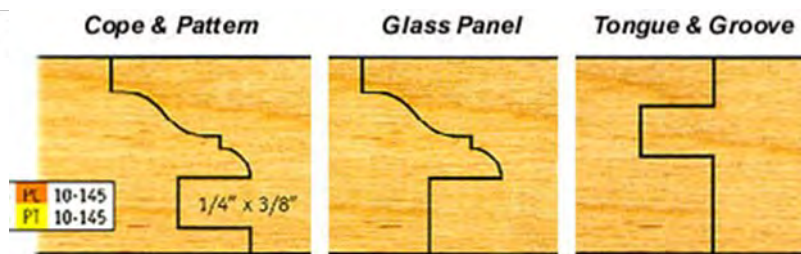

Item #	Freeborn	Cutter Set Type	Material	Price
810 10-145C	PC-10-145	COPE AND PATTERN SETS (6 CUTTERS)	CARBIDE	\$ 561.45
810 10-145T	PT-10-145	COPE AND PATTERN SETS (6 CUTTERS)	TANTUNG	\$ 642.20

1" to 1-1/4" material

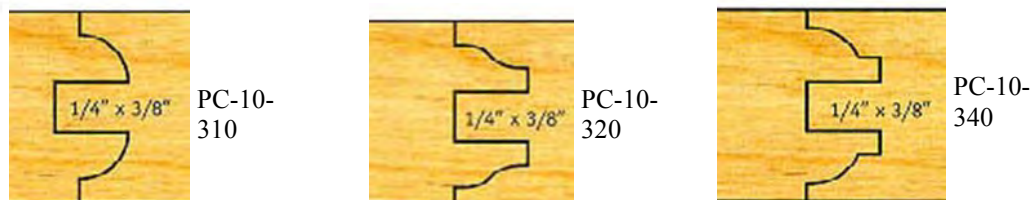

Item #	Freeborn	Cutter Set Type	Material	Price
81010-310 C	PC-10-310	COPE AND PATTERN SETS (6 CUTTERS)	CARBIDE	\$608.95
81010-310 T	PT-10-310	COPE AND PATTERN SETS (6 CUTTERS)	TANTUNG	\$694.45
81010-320 C	PC-10-320	COPE AND PATTERN SETS (6 CUTTERS)	CARBIDE	\$608.95
81010-320 T	PT-10-320	COPE AND PATTERN SETS (6 CUTTERS)	TANTUNG	\$694.45
81010-340 C	PC-10-340	COPE AND PATTERN SETS (6 CUTTERS)	CARBIDE	\$608.95
81010-340 T	PT-10-340	COPE AND PATTERN SETS (6 CUTTERS)	TANTUNG	\$694.45

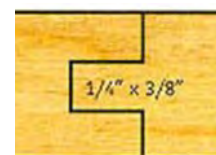

PC-10-310



PC-10-310

3/4" to 1-1/8" material

Item #	Freeborn	Cutter Set Type	Material	Price
810 10-500C	PC-10-500	COPE AND PATTERN SETS (6 CUTTERS)	CARBIDE	\$437.95
810 10-500T	PT-10-500	COPE AND PATTERN SETS (6 CUTTERS)	TANTUNG	\$481.65
810 10-550C	PC-10-550	COPE AND PATTERN SETS (6 CUTTERS)	CARBIDE	\$437.95
810 10-550T	PT-10-550	COPE AND PATTERN SETS (6 CUTTERS)	TANTUNG	\$481.65

1/2" Raised Panel Cutter

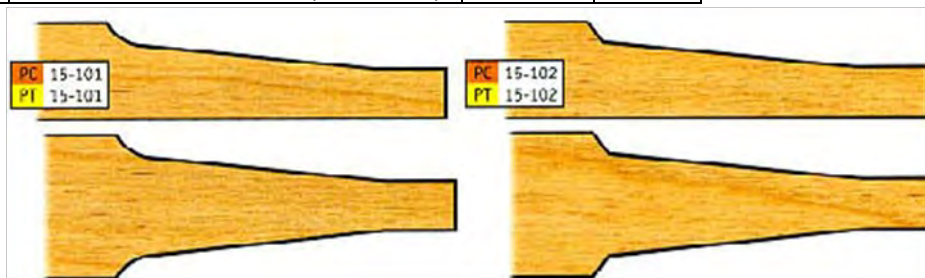

Item #	Freeborn	Cutter Type	Material	Price
81015-101 C	PC-15-101	1/2" THICK RAISED PANEL	CARBIDE	\$272.65
81015-101 T	PT-15-101	1/2" THICK RAISED PANEL	TANTUNG	\$300.20
81015-102 C	PC-15-102	1/2" THICK RAISED PANEL	CARBIDE	\$272.65
81015-102 T	PT-15-102	1/2" THICK RAISED PANEL	TANTUNG	\$300.20

INSERT RAISED PANEL CUTTER HOLDERS

Insert tool holders to allow you to design your own custom raised panel are available. Call to request pricing with your custom design.

Double Sided Cope and Pattern Sets

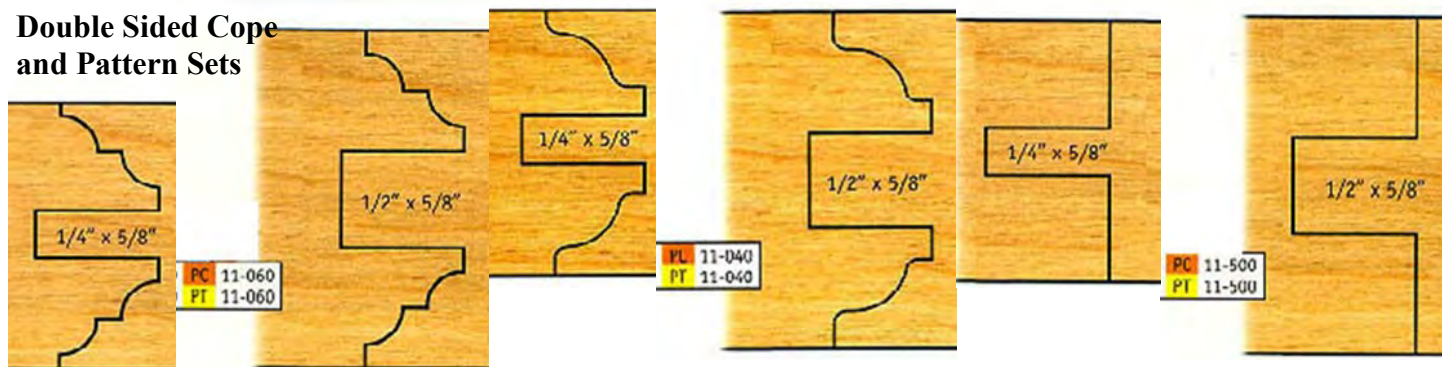

Item #	Freeborn	Cutter Set Type	Material	Price
810 11-010C	PC-11-010	DOUBLE COPE AND PATTERN (8 CUTTERS)	CARBIDE	\$969.95
810 11-010T	PT-11-010	DOUBLE COPE AND PATTERN (8 CUTTERS)	TANTUNG	\$1,066.85
810 11-020C	PC-11-020	DOUBLE COPE AND PATTERN (8 CUTTERS)	CARBIDE	\$969.95
810 11-020T	PT-11-020	DOUBLE COPE AND PATTERN (8 CUTTERS)	TANTUNG	\$1,066.85
810 11-030C	PC-11-030	DOUBLE COPE AND PATTERN (8 CUTTERS)	CARBIDE	\$969.95
810 11-030T	PT-11-030	DOUBLE COPE AND PATTERN (8 CUTTERS)	TANTUNG	\$1,066.85
810 11-040C	PC-11-040	DOUBLE COPE AND PATTERN (8 CUTTERS)	CARBIDE	\$969.95
810 11-040T	PT-11-040	DOUBLE COPE AND PATTERN (8 CUTTERS)	TANTUNG	\$1,066.85

5/8" Raised Panel Cutters



Item #	Freeborn	Cutter Type	Material	Price
810 15-001 C	PC-15-001	5/8" THICK RAISED PANEL	CARBIDE	\$272.65
810 15-001 T	PT-15-001	5/8" THICK RAISED PANEL	TANTUNG	\$300.20
810 15-002 C	PC-15-002	5/8" THICK RAISED PANEL	CARBIDE	\$272.65
810 15-002 T	PT-15-002	5/8" THICK RAISED PANEL	TANTUNG	\$300.20
810 15-003C	PC-15-003	5/8" THICK RAISED PANEL	CARBIDE	\$272.65
810 15-003T	PT-15-003	5/8" THICK RAISED PANEL	TANTUNG	\$300.20
810 15-004C	PC-15-004	5/8" THICK RAISED PANEL	CARBIDE	\$272.65
810 15-004T	PT-15-004	5/8" THICK RAISED PANEL	TANTUNG	\$300.20
810 15-005C	PC-15-005	5/8" THICK RAISED PANEL	CARBIDE	\$272.65
810 15-005T	PT-15-005	5/8" THICK RAISED PANEL	TANTUNG	\$300.20
810 15-006C	PC-15-006	5/8" THICK RAISED PANEL	CARBIDE	\$272.65
810 15-006T	PT-15-006	5/8" THICK RAISED PANEL	TANTUNG	\$300.20
810 15-007C	PC-15-007	5/8" THICK RAISED PANEL	CARBIDE	\$272.65
810 15-007T	PT-15-007	5/8" THICK RAISED PANEL	TANTUNG	\$300.20
810 15-008C	PC-15-008	5/8" THICK RAISED PANEL	CARBIDE	\$272.65
810 15-008T	PT-15-008	5/8" THICK RAISED PANEL	TANTUNG	\$300.20
810 15-009C	PC-15-009	5/8" THICK RAISED PANEL	CARBIDE	\$272.65
810 15-009T	PT-15-009	5/8" THICK RAISED PANEL	TANTUNG	\$300.20
810 15-010C	PC-15-010	5/8" THICK RAISED PANEL	CARBIDE	\$272.65
810 15-010T	PT-15-010	5/8" THICK RAISED PANEL	TANTUNG	\$300.20
810 15-011C	PC-15-011	5/8" THICK RAISED PANEL	CARBIDE	\$272.65
810 15-011T	PT-15-011	5/8" THICK RAISED PANEL	TANTUNG	\$300.20
810 15-012C	PC-15-012	5/8" THICK RAISED PANEL	CARBIDE	\$272.65
810 15-012T	PT-15-012	5/8" THICK RAISED PANEL	TANTUNG	\$300.20
810 15-013C	PC-15-013	5/8" THICK RAISED PANEL	CARBIDE	\$272.65
810 15-013T	PT-15-013	5/8" THICK RAISED PANEL	TANTUNG	\$300.20

3/4" Raised Panel Cut-

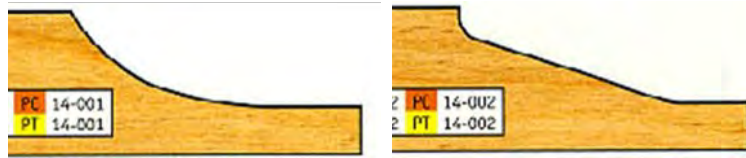
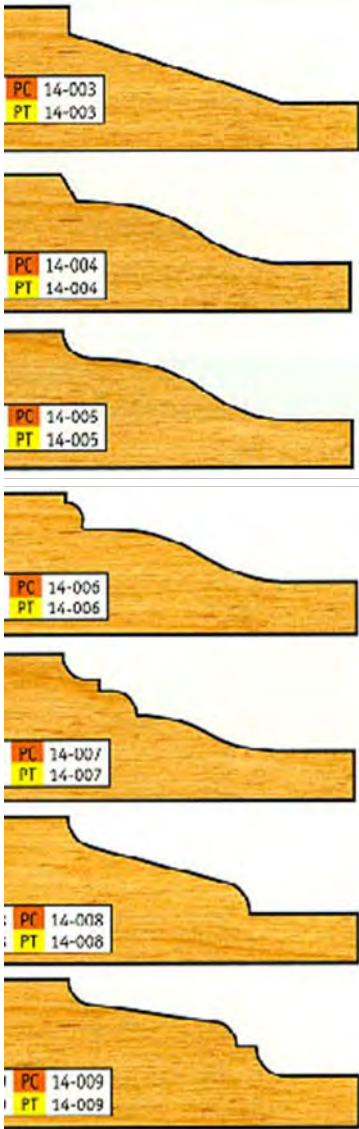

Item #	Freeborn	Cutter Type	Material	Price
81014-001 C	PC-14-001	3/4" THICK RAISED PANEL	CARBIDE	\$272.65
81014-001 T	PT-14-001	3/4" THICK RAISED PANEL	TANTUNG	\$300.20
81014-002 C	PC-14-002	3/4" THICK RAISED PANEL	CARBIDE	\$272.65
81014-002 T	PT-14-002	3/4" THICK RAISED PANEL	TANTUNG	\$300.20
81014-003 C	PC-14-003	3/4" THICK RAISED PANEL	CARBIDE	\$272.65
81014-003 T	PT-14-003	3/4" THICK RAISED PANEL	TANTUNG	\$300.20
81014-004 C	PC-14-004	3/4" THICK RAISED PANEL	CARBIDE	\$272.65
81014-004 T	PT-14-004	3/4" THICK RAISED PANEL	TANTUNG	\$300.20
81014-005 C	PC-14-005	3/4" THICK RAISED PANEL	CARBIDE	\$272.65
81014-005 T	PT-14-005	3/4" THICK RAISED PANEL	TANTUNG	\$300.20
81014-006 C	PC-14-006	3/4" THICK RAISED PANEL	CARBIDE	\$272.65
81014-006 T	PT-14-006	3/4" THICK RAISED PANEL	TANTUNG	\$300.20
81014-007 C	PC-14-007	3/4" THICK RAISED PANEL	CARBIDE	\$272.65
81014-007 T	PT-14-007	3/4" THICK RAISED PANEL	TANTUNG	\$300.20
81014-008 C	PC-14-008	3/4" THICK RAISED PANEL	CARBIDE	\$272.65
81014-008 T	PT-14-008	3/4" THICK RAISED PANEL	TANTUNG	\$300.20
81014-009 C	PC-14-009	3/4" THICK RAISED PANEL	CARBIDE	\$272.65
81014-009 T	PT-14-009	3/4" THICK RAISED PANEL	TANTUNG	\$300.20
81014-010 C	PC-14-010	3/4" THICK RAISED PANEL	CARBIDE	\$272.65
81014-010 T	PT-14-010	3/4" THICK RAISED PANEL	TANTUNG	\$300.20
81014-011 C	PC-14-011	3/4" THICK RAISED PANEL	CARBIDE	\$272.65
81014-011 T	PT-14-011	3/4" THICK RAISED PANEL	TANTUNG	\$300.20
81014-012 C	PC-14-012	3/4" THICK RAISED PANEL	CARBIDE	\$272.65
81014-012 T	PT-14-012	3/4" THICK RAISED PANEL	TANTUNG	\$300.20
81014-013 C	PC-14-013	3/4" THICK RAISED PANEL	CARBIDE	\$272.65
81014-013 T	PT-14-013	3/4" THICK RAISED PANEL	TANTUNG	\$300.20

Back and Trim Cut-

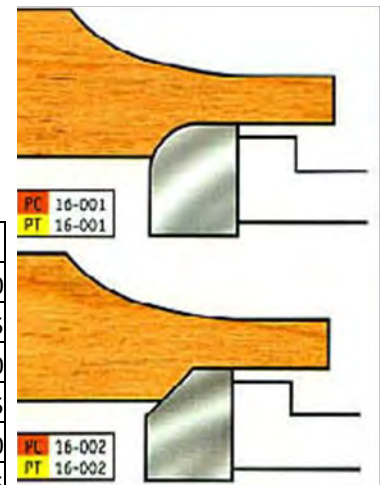
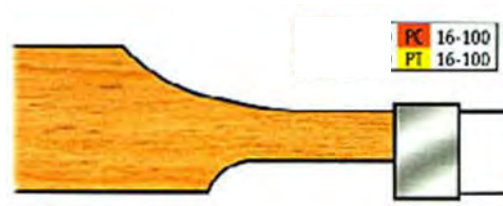

Item #	Freeborn	Cutter Type	Material	Price
810 16-001C	PC-16-001	BACK CUTTER FOR RAISED PANNEL	CARBIDE	\$199.50
810 16-001T	PT-16-001	BACK CUTTER FOR RAISED PANNEL	TANTUNG	\$219.45
810 16-002C	PC-16-002	BACK CUTTER FOR RAISED PANNEL	CARBIDE	\$199.50
810 16-002T	PT-16-002	BACK CUTTER FOR RAISED PANNEL	TANTUNG	\$219.45
810 16-100C	PC-16-100	EDGE TRIM CUTTER	CARBIDE	\$199.50
810 16-100T	PT-16-100	EDGE TRIM CUTTER	TANTUNG	\$219.45

MultiFUNCTION

by  **HAWK** Woodworking Tools™
Bushton Manufacturing • Bushton, KS

WOOD PLANER/MOLDER/GANG SAW/SANDER



WE DO SPECIAL FUNCTIONS AND
MODIFICATIONS
SUCH AS
DIAMOND HEADS AND SPECIAL
CONTROLS FOR GLASS-EPOXY
COMPOSITE MATERIALS

FEATURES

SIMPLE HEAD CHANGE only one allen wrench required.

QUICK CHANGE HEAD converts from a planer, to a molder, to a gang saw, to a sander in just a few minutes.

3 KNIFE CORRUGATED CUTTER HEAD easy to set, no gauge required.

HIGH SPEED BEARINGS are self-aligning for years of trouble free service.

ADJUSTABLE BED of precision ground steel.

HEAVY DUTY V-BELT DRIVE delivers maximum power to the cutter head for all applications with a single belt.

INDUSTRIAL GRADE 5 HP MOTOR to give years of dependable service.

MAGNETIC SAFETY SWITCH IS STANDARD, this is required by OSHA for commercial applications.

NON-MARRING URETHANE IN/OUT FEED ROLLERS that feed the wood into the planer leaving no marks nicks or cuts.

1/4 HP DC FEED GEAR-MOTOR is controlled by a industrial grade PWM speed controller for a constant feed rate adjusted by the turn of a knob.

VARIABLE FEED RATE goes from nearly zero to 22' per minute.

SMOOTH BELT DRIVE on feed roller yields trouble free operation with no chains or sprockets to trap wood chips.

HEAVY GAUGE STEEL BASE designed for years of demanding use.

MADE IN THE USA.

This machine can pay for itself in just one job.

If you compare the price for baseboards, casements, chair rail, crown rail frames and any other molding you will use in a house, you will find that you can buy the **HAWK MultiFUNCTION PLANER** and the needed heads, and accessories and rough-cut lumber for less than the price of buying the molding. Do it your self and save money and have the exact moldings that you want. We have over 450 design in our molding profile catalog and will cut the knives for any profile you can draw or send in a sample of. Request a free copy of the Molding Profile Catalog today.

PRICING 820

Single Function*	\$ 2850
Two Functions*	\$ 3250
Three Functions*	\$ 3650
Four Functions*	\$ 4050

*Spiral cutting head available for an additional cost of \$800 above standard planning head.

SPECIFICATIONS

	820 (900-0820)
Maximum Width	20 1/8"
Stock Thickness Range	3/16" to 8"
Maximum Depth of Cut	5/16"
Minimum Stock Length	10"
Feed Rollers	1 7/8" Urethane
Feed Rate (variable speed)	0 to 25 ft per min
Feed Gear Motor	180 V DC
Motor Voltage	240 V
Phase standard	1
Phase optional	3 (\$100 deduction)
Horsepower	5
Hp Optional (3 ph)	7.5 (\$100 Addition)
RPM	1750
Cutting Head RPM	4350
Sanding Head RPM	2700
Shipping Weight	

PLANER

Now you can have the satisfaction of knowing you have done everything you can from start to finish to make each of your woodworking projects their very best. Use the **HAWK MultiFUNCTION Planer** to finish your own lumber turning rough cut stock into precision-milled lumber in just minutes. Buy your own rough cut lumber direct from the saw mill, then surface it yourself and pocket the savings. You will be able to use the best lumber for a fraction of the cost. You will be able to save 50% on the lumber costs of your projects. You determine the perfect piece for your project, and then you cut it and finish it yourself by just dialing in the exact dimensions needed.



Simply drop the knife into the corrugation that's milled right into the planer head, tighten the blade into position and you're set. Do it all in 5 minutes or less!

SPIRAL HEAD

You will have finished thickness lumber you will be proud of from the **MultiFUNCTION Planer**. Whether you use the corrugated planer knife head, which eliminates the need for setting the blade height, or you use our spiral cutter head, which uses 1/2" square micro-carbide inserts it is your choice.



GANG SAW

Now that you have your lumber the thickness that you need you can remove the planer head and insert in the gang saw head in just a couple of minutes. All you need to do is remove the top cover, undo the 2 bolts on top of both bearing mounts, remove the top of the bearing mounts, remove the head, place in the gang saw head and put it back together. With this attachment you can

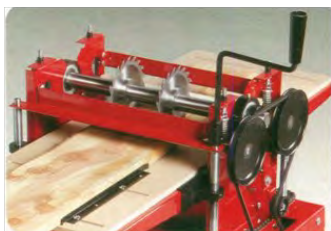

rip your lumber to width. It will allow you to rip the exact width repeatedly and quickly without the problems of holding the lumber against a table saw fence.

MOLDER

Once again you can remove your head and place in the custom molding knife head in just a couple of minutes. Whether you plan to make moldings and picture frames for your own use or start your own commercial production shop, the **HAWK MultiFUNCTION Planer** is the right tool for the job. We have over 500 standard molding profiles knives you can order or send us your own pattern and we will make custom molding knives to your specifications.



Then with one pass you will have the molding or your choice. You will no longer be limited to what your local lumber yard stocks.



Make curved moldings by making your own guides to match the molding curve and pre cutting the curved board for the molding.

MOLDING KNIVES

With the **HAWK MultiFUNCTION Planer** you can start your own successful business in which you design and create your own custom molding or recreate historic antique moldings. You can do it easily and affordably with a little help from the **HAWK Custom Knife Department** here at Bushton Manufacturing. We have a large catalog of over 500 standard molding knives.

- We can also supply custom molding knives upon request.
- Signed copy of all custom knife quotes is required with payment before a custom knife can be made.
- Sharpening template is supplied with all custom knife orders.
- **All custom molding knives must be paid for before the knife is cut and are non refundable.**
- Knives are priced per knife with gib and balances are sold separately and are priced at 15% of the knife. For a 2 knife head you must order 2 knives or 1 knife and a balance.
- Knife orders take about 1 week after they are paid for.



SANDER

It is time to finish your lumber by sanding it. As before, remove the head that is in it and place in the sanding head. The Velcro attached paper can easily be changed from one grit to another. We stock sand paper from 60 to 220 grit to meet your sanding needs.

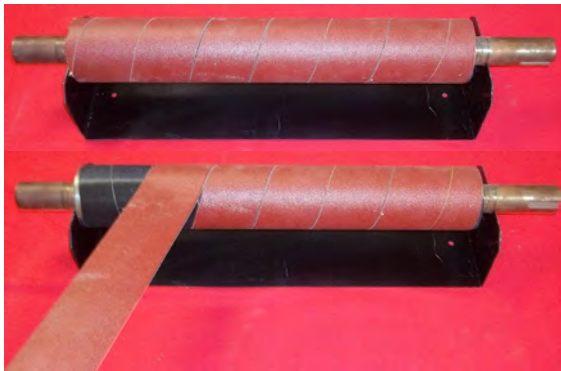

SPECIAL FUNCTIONS

GLASS EPOXY, PLASTIC. If you have a special need we will develop a planer to meet your needs.

PLANER KNIVES price per each

803-0000	8" Planer Knife	\$14.00
803-0001	12.5" Planer Knife	\$14.50
803-0002	20.5" Planer Knife	\$21.00
803-0003	16.5" Planer Knife	\$18.00
803-0004	15.5" Corrugated Knife	\$29.95
803-0005	20.5" Corrugated Knife	\$39.00



FEED ROLLERS

Urethane feed rollers.		
645-0068	8"	\$76.00
695-0066	12"	\$76.00
646-0018	15"	\$84.15
634-0017	16"	\$95.00
645-0736	20"	\$109.25
765-0057	Feed Roller Bushing	\$7.50
765-0019	Feed Roller Spring	\$4.00
745-2091	Feed Roller Pulley	\$19.95



HDPE GUIDE BOARDS

To guide the boards through the gang saw and molder, we have HDPE guide boards for smooth low friction feeding. The metal guide rails keep the boards aligned through the gang saw or molder.

Xxx-xxxx	Guide Board for 820 Planer	\$
Xxx-xxxx	Guide Board and Rail Kit for 820 Planer	\$
Xxx-xxxx	Guide Board for 615 Planer	\$
Xxx-xxxx	Guide Board and Rail Kit for 615 Planer	\$



Xxx-xxxx only	Guide Rail Kit	\$
---------------	----------------	----

HEADS

CALL FOR HEAD PRICING
PLANER, SPIRAL PLAN-
ER, GANG SAW,
MOLDING, SANDING

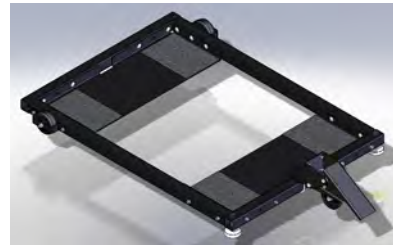

MOBILE BASE 910-2500 \$250

GANG SAW BLADES AND HUBS

745-0754	Gang Saw Blade 6 1/2"	\$39.95
745-0409	Gang Saw Blade 5 1/2"	\$39.95
645-1/2"	0409 Saw Blade Hub Set for 1-	
816,	820) Shaft Planers (612, 720,	
		\$39.95



VELCRO AND VECRO BACK SAND PAPER

Velcro Grip Sandpaper 3"x75' roll
\$42.00 per roll \$1.00 per foot

801-2060	60 grit
801-2080	80 grit
801-2100	100 grit
801-2150	150 grit
801-2180	180 grit
801-2220	220 grit



PARTS PLANATARY GEAR DRIVE

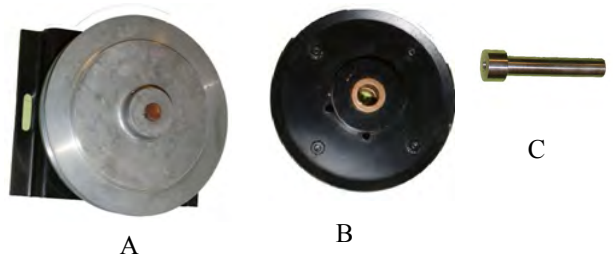
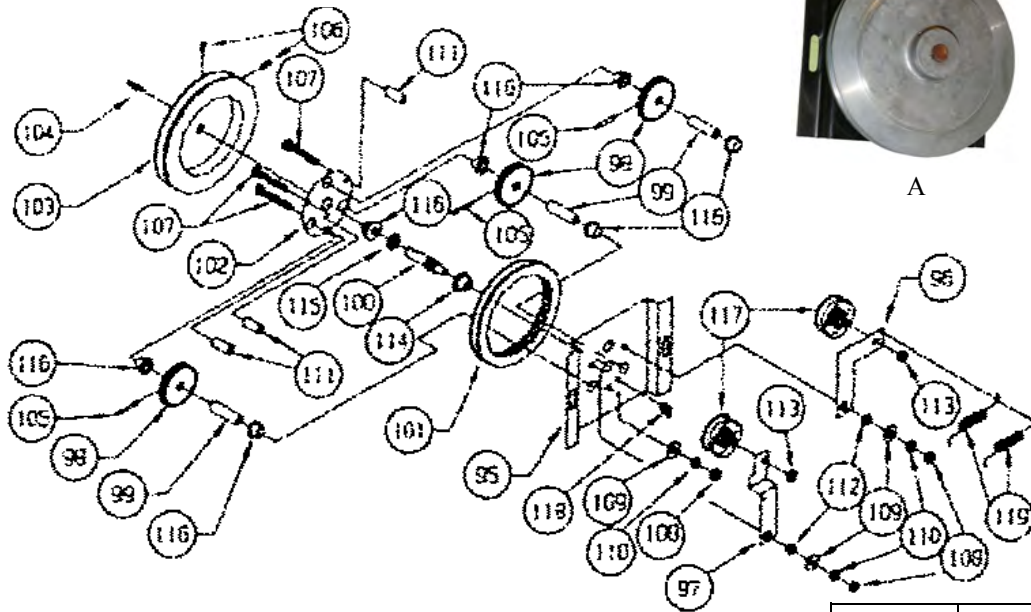

CORRUGATED MOLDING KNIFE HOLDERS



Item #	Part #	Discription	Price
95	645-0089	Gearbox Back Plate	\$2.95
98	645-0068	Internal Gear	\$50.00
99	645-0096	Internal gear shaft	\$3.95
100	645-0090	Pinion Gear	\$65.00
101	645-2088	Reduction Input Sheave	\$39.95
102	645-0067	Face Plate	\$12.95
103	645-0095	Internal Gear Sheave	\$19.95
104	745-0057	#5 Woodruff Key	\$0.50
105	745-0071	3/16 x 1-1/4 Roll Pin	\$0.50
106	745-0161	1/4- 20 x 1/2 socket set screw	\$0.50
107	750-0203	5/16 - 18 x 2" Hex Head Bolt	\$0.50
108	770-0081	5/16-18 Hex Nut	\$0.50
109	745-0150	5/16" Flat Washer	\$0.50
110	770-0178	5/16" Split Lock Washer	\$0.50
111	745-0094	5/16 x 1-1/16 Spacer	\$0.50
114	745-0073	3/8 ID Flange Bronze Bushing	\$1.50
115	745-0160	1/2 ID x 7/8 OD x 14 ga. Bushing	\$0.50
116	740-0369	1/2" ID Flanged Bronze Bushing	\$0.50
118	750-0210	Grease Zerk 90 Degree	\$2.95
A	645-0156	Gear Box includes all above parts	\$285.00
		Additional Parts	
97	645-0146	Reducer Drive Idler Arm	\$3.95
96	645-0145	Internal Arm Feed Roller	\$4.95
112	745-0158	5/16ID X 1/2OD X 3/16 Spacer	\$0.50
113	770-0058	3/8- 16 Hex Nut	\$0.50
117	745-0062	Pulley, 2" Idler	\$13.50
119	745-0063	Tension Spring	\$4.00
		Parts Not Pictured	
B	645-1153	Dual V-Pulley bushings not included	\$34.95
C	695-3022	Shoulder Shaft	\$25.00
D	740-0368	Bushing for Dual V-Pulley	\$3.00

HOLDER	NUMBER OF KIFE SLOTS	FOR PLANER MODEL	PRICE
901-0502	2 CORRUGATED BACK	408, 812	\$100.00
901-0503	1 CORRUGATED BACK	612, 615, 720, 816, 820	\$ 85.00
901-0504	2 CORRUGATED BACK	612, 615, 720, 816, 820	\$100.00
901-0505	3 CORRUGATED BACK	612, 615, 720, 816, 820	\$140.00

GIBS AND COUNTER BALANCES

Call for pricing on gibs.

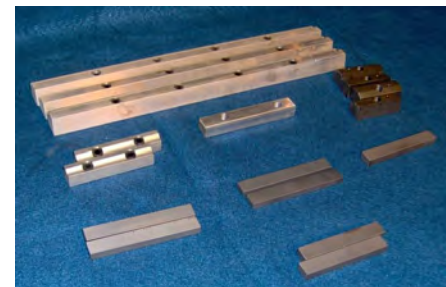

BELTS



Item #	Price Each
745-0721	\$18.76
745-0723	\$19.90
745-0724	\$20.58
745-0728	\$9.62
745-0729	\$9.70
745-0730	\$13.56
745-0734	\$13.56
745-0735	\$10.96
745-0743	\$19.26
745-0749	\$17.50
745-0750	\$16.00
745-0753	\$20.20
745-0760	\$21.08
745-0761	745-0760

Item #	Price Each
745-0773	\$21.92
745-0774	\$22.04
745-0777	\$16.92
745-1683	\$5.00
746-0044	\$15.58
746-0055	\$16.86
775-0121	\$20.78
790-0048	\$17.16
790-0052	\$11.96
790-0077	\$18.60
790-0128	\$22.04
790-0130	\$22.94
790-1128	\$16.66
799-9999	\$5.00

MOLDING KNIVES STANDARD AND CUSTOM

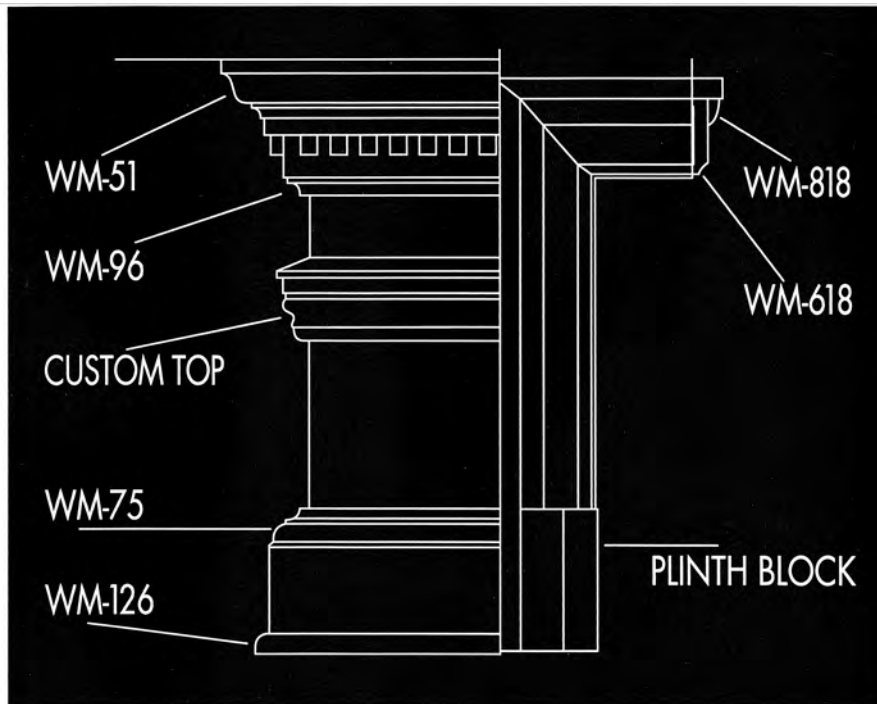

We have a molding knife for every need. Request our Molding Profile Catalog to see the over 500 standard knives and how to order the custom knife you need to do your project. If you want it we will make it. All custom knives must be paid for at time of order and are non refundable.

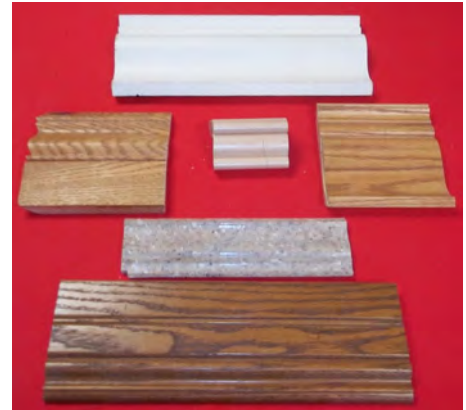

ROSETTE CUTTERS HOLDERS AND KNIVES

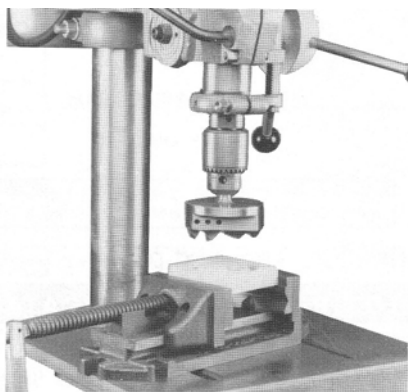

904-0100 HOLDER \$65.00

Just use your drill press to make rosettes to go along with the molding. We have molding profiles to match the rosette patterns we have. We can make custom knives to fit your needs.

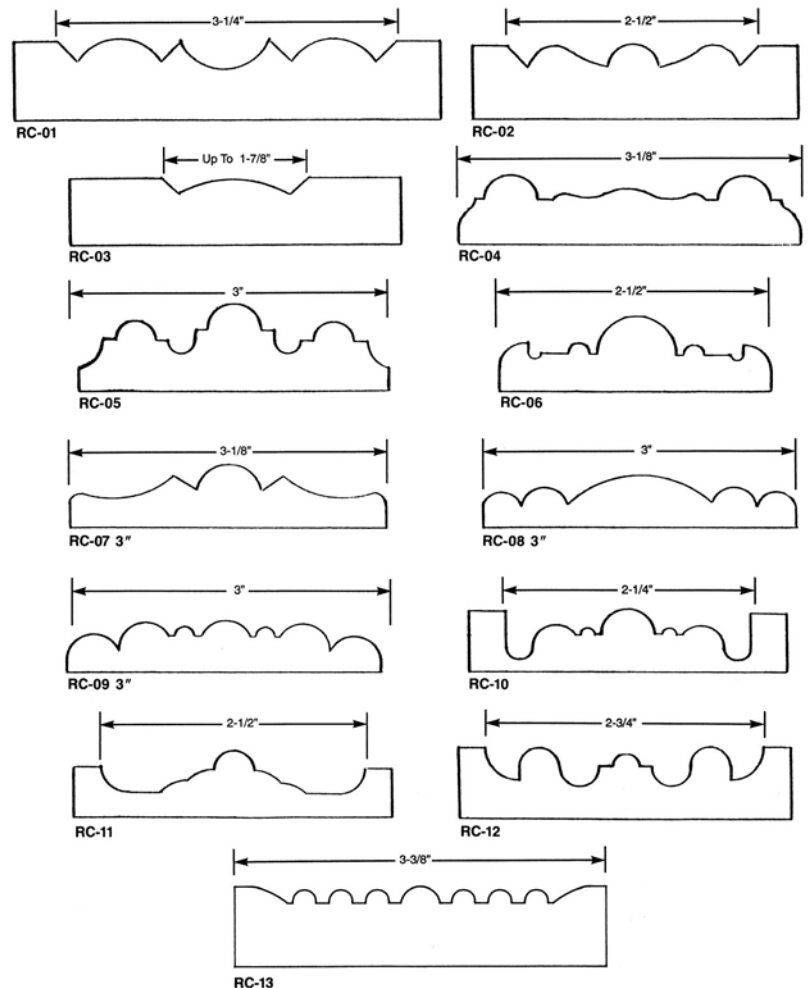

ROSETTE CUTTER	ITEM #	Price per Pair	ROSETTE CUTTER	ITEM #	Price per Pair
RC-01	904-0101	\$85.00	RC-08	904-0108	\$80.00
RC-02	904-0102	\$70.00	RC-09	904-0109	\$80.00
RC-03	904-0103	\$57.50	RC-10	904-0110	\$65.00
RC-04	904-0104	\$82.50	RC-11	904-0111	\$70.00
RC-05	904-0105	\$80.00	RC-12	904-0112	\$75.00
RC-06	904-0106	\$70.00	RC-13	904-0113	\$87.00
RC-07	904-0107	\$82.50			

HAWK Versatility

We here at Bushton Manufacturing pride ourselves and our ***HAWK*** tool line on it's exceptional versatility. Each tool fits comfortably in any environment whether it's in a hobbyists workspace, a small family business, a large industrial shop, or even a local school. The ***HAWK Multi-FUNCTION Planer*** and the ***HAWK RouterSHOP*** are two tools that will perform a wide variety of functions in a small space and without the hassle of multiple tool setups.

The ***HAWK MultiFUNCTION Planer*** can be built to custom specifications if needed. Standard, this wide-ranging machine will perform several functions with a very simple four-screw head change.



The ***HAWK RouterSHOP*** is so much more than just a router table. It performs a wide variety of functions that usually require specialty bits, custom guides, and/or completely separate machines!

- ◆ Dowel and Biscuit holes
- ◆ Dovetails
- ◆ Edge Jointing
- ◆ Mortise and Tenon
- ◆ Tongue and Groove
- ◆ Rails and Stiles Making
- ◆ Raised Panel Making
- ◆ Shaping
- ◆ Molding
- ◆ And Much More!



The AtomPOP is a no-shake, no-stir popper produced by Bushton Manufacturing's sister company, Quincraft Products. It has been in production since 1952 and still makes the best popcorn around. Ask us about it when you call in!



The projects in this catalog were done by customers. We are working on a project called "What Can You Do With A ***HAWK***?" and would like some more photos of projects you are currently working on! Send them to the address or email listed below.

